

# 04

## IMPACT TOOLS

<b>IMPACT-TOOLS 1/4"</b>	Page 190
<b>IMPACT-TOOLS 3/8"</b>	Page 193
<b>IMPACT-TOOLS 1/2"</b>	Page 196
<b>IMPACT-TOOLS 3/4"</b>	Page 202
<b>IMPACT-TOOLS 1"</b>	Page 206
<b>IMPACT-TOOLS 1.1/2"</b>	Page 210
<b>IMPACT-TOOLS 2.1/2"</b>	Page 214
<b>IMPACT-SCREWDRIVER INSERT BITS AND BIT COUPLERS</b>	Page 216

**788-..., 788A-...**

**IMPACT SOCKET 1/4", HEXAGON**

- for power tools
- special steel, phosphated
- female square drive according to DIN 3121-G 6,3, ISO 1174
- according to DIN 3129, ISO 2725-2

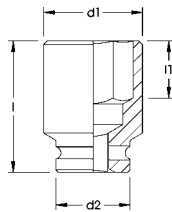

6,3

1/4"



Code	Number	l/mm	l1 mm	d1 mm	d2 mm	Locking Pin	Locking Ring	Pieces	Weight/g
0788000405100	788-4	23	4	7,5	13	7883-11	7884-11	6	14
0788000455100	788-4,5	23	4	8	13	7883-11	7884-11	6	14
0788000505100	788-5	23	5	8,5	13	7883-11	7884-11	6	14
0788000555100	788-5,5	23	5	9	13	7883-11	7884-11	6	14
0788000605100	788-6	23	6	10	13	7883-11	7884-11	6	14
0788000705100	788-7	23	6	11	13	7883-11	7884-11	6	15
0788000805100	788-8	23	7	12	13	7883-11	7884-11	6	15
0788000905100	788-9	23	7	13	13	7883-11	7884-11	6	15
0788001005100	788-10	23	7	14,5	13	7883-11	7884-11	6	17
0788001105100	788-11	23	8	16	13	7883-11	7884-11	6	17
0788001205100	788-12	23	9	17	13	7883-11	7884-11	6	18
0788001305100	788-13	23	9	18	13	7883-11	7884-11	6	18
0788001405100	788-14	23	9	20	13	7883-11	7884-11	6	24
0788001705100	788-17	26	10	24	13	7883-11	7884-11	6	35



Code	Number	l/mm	l1 mm	d1 mm	d2 mm	Locking Pin	Locking Ring	Pieces	Weight/g
0788100135100	788A-1/4	23	5	10,5	13	7883-11	7884-11	6	15
0788100175100	788A-5/16	23	5	12	13	7883-11	7884-11	6	15
0788100185100	788A-11/32	23	5	13	13	7883-11	7884-11	6	15
0788100215100	788A-7/16	23	7	16	13	7883-11	7884-11	6	17
0788100235100	788A-1/2	23	8	18	13	7883-11	7884-11	6	18

**796-E...**

**IMPACT SOCKET 1/4"**

- for outside TORX® screws
- for power tools
- special steel, phosphated
- female square according to DIN 3121-G6, 3, ISO 1174
- TORX® = reg. trademark of Acument Intellectual Properties, LLC. USA

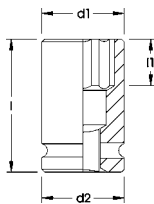

6,3

1/4"

Code	Number	l/mm	l1 mm	d1 mm	d2 mm	Locking Pin	Locking Ring	Pieces	Weight/g	
0796000045000	796-E4	3,86	23	3,2	7,4	13	7883-11	7884-11	6	15
0796000055000	796-E5	4,73	23	3,2	8,3	13	7883-11	7884-11	6	15
0796000065000	796-E6	5,74	23	4	9,3	13	7883-11	7884-11	6	15
0796000075000	796-E7	6,16	23	4,8	9,8	13	7883-11	7884-11	6	15
0796000085000	796-E8	7,52	23	5,6	11,1	13	7883-11	7884-11	6	15
0796000105000	796-E10	9,42	23	6,4	13	13	7883-11	7884-11	6	16

## 7900-... IMPACT EXTENSION BAR 1/4"

- ▶ for power tools
- ▶ special steel, phosphated
- ▶ square according to DIN 3121, form F and G, ISO 1174

6,3

1/4"



Code	Number	l/mm	Locking Pin	Locking Ring	Pieces	Weight/g
7900000505100	7900-50	50	7883-11	7884-11	6	28
7900001005100	7900-100	100	7883-11	7884-11	6	48

## 795-1/4 IMPACT UNIVERSAL JOINT 1/4"

- ▶ for power tools
- ▶ special steel, phosphated
- ▶ square according to DIN 3121, form F and G, ISO 1174

6,3

1/4"



Code	Number	l/mm	Locking Pin	Locking Ring	Pieces	Weight/g
0795100135100	795-1/4	40	7883-13	7884-14	3	25

## 7907-... IMPACT ADAPTOR

- ▶ for power tools
- ▶ special steel, phosphated
- ▶ square according to DIN 3121, form F and G, ISO 1174

6,3

1/4"



Code	Number	□	■	l/mm	Locking Pin	Locking Ring	Pieces	Weight/g
7907100175100	7907-5/16	1/4"	5/16"	25	7883-11	7884-11	3	18
7907100195100	7907-3/8	1/4"	3/8"	25	7883-11	7884-11	3	20

You will find the matching socket rails on page no. 123



### 4140-...

#### ADAPTOR 1/4"

- for power tools
- ELORA-Nr. 4140-50: male square drive according to DIN 3121 E 6,3, ISO 1174 with locking pin, according to DIN 7428, ISO 3317
- ELORA-Nr. 4140-100: male square drive according to DIN 3120 A 6,3, ISO 1174 with ball locking device

6,3

1/4"



Code	Number	l/mm			Pieces	Weight/g
4140000505200	4140-50	50	1/4"	1/4"	6	15,6
4140001005200	4140-100	100	1/4"	1/4"	6	38,0

### 7883-.../7884-...

#### IMPACT LOCKING PIN AND RING FOR IMPACT SOCKET 1/4"

- for locking impact sockets and operating tools
- locking pin made of alloyed special steel
- locking ring made of rubber elastic and oil resistant material



Code	Number	l/mm	mm Ø	Pieces	Weight/g
7883000115100	7883-11	11	1,5	12	0,2
7883000135100	7883-13	13	1,5	12	0,2
7884000115100	7884-11	-	11	12	0,2
7884000145100	7884-14	-	14	12	0,2



**789-.../789A-...**

**IMPACT SOCKET 3/8", HEXAGON**

- for power tools
- special steel, phosphated
- female square drive according to DIN 3121-G 10, ISO 1174
- according to DIN 3129, ISO 2725-2

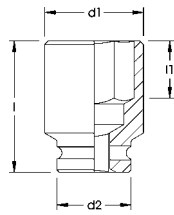

10

3/8"



Code	Number	l/mm	l1 mm	d1 mm	d2 mm	Locking Pin	Locking Ring	Pieces	Weight/g
0789000605100	789-6	32	5	11,3	19	7893-15	7894-15	6	40
0789000705100	789-7	32	5	12,5	19	7893-15	7894-15	6	40
0789000805100	789-8	32	6	13,7	19	7893-15	7894-15	6	40
0789000905100	789-9	32	6	15,0	19	7893-15	7894-15	6	40
0789001005100	789-10	32	7	16,3	19	7893-15	7894-15	6	41
0789001105100	789-11	32	7	17,5	19	7893-15	7894-15	6	41
0789001205100	789-12	32	8	19,0	19	7893-15	7894-15	6	58
0789001305100	789-13	32	8	20,0	22	7893-18	7894-18	6	40
0789001405100	789-14	32	9	21,3	22	7893-18	7894-18	6	58
0789001505100	789-15	32	9	22,5	22	7893-18	7894-18	6	58
0789001605100	789-16	32	10	23,8	22	7893-18	7894-18	6	58
0789001705100	789-17	32	10	25,0	22	7893-18	7894-18	6	66
0789001805100	789-18	32	11	26,3	22	7893-18	7894-18	6	66
0789001905100	789-19	32	12	27,5	22	7893-18	7894-18	6	66
0789002005100	789-20	34	12	29,0	22	7893-18	7894-18	6	75
0789002105100	789-21	34	13	30,0	22	7893-18	7894-18	6	75
0789002205100	789-22	34	14	31,3	22	7893-18	7894-18	6	75
0789002305100	789-23	34	15	32,5	22	7893-18	7894-18	6	75
0789002405100	789-24	36	16	33,8	22	7893-18	7894-18	6	75



Code	Number	l/mm	l1 mm	d1 mm	d2 mm	Locking Pin	Locking Ring	Pieces	Weight/g
0789100175100	789A-5/16	29,5	5	12,5	19	7893-15	7894-15	6	40
0789100215100	789A-7/16	29,5	7	17,0	19	7893-15	7894-15	6	41
0789100235100	789A-1/2	29,5	7	20,0	19	7893-15	7894-15	6	55
0789100245100	789A-9/16	31,5	8	22,0	22	7893-18	7894-18	6	56
0789100315100	789A-7/8	34	12	31,0	25	7893-18	7894-18	6	75

**789MG-...**

**IMPACT SOCKET 3/8", WITH MAGNETIC INSERT, HEXAGON**

- for power tools
- special steel, gunmetal-finish
- female square drive according to DIN 3121-G 10, ISO1174
- according to DIN 3129, ISO 2725-2

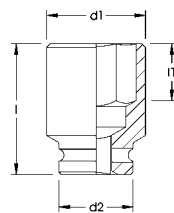

10

3/8"



Code	Number	l/mm	l1 mm	d1 mm	d2 mm	Locking Pin	Locking Ring	Pieces	Weight/g
0789016085100	789MG-8	30	4	14,5	19	7893-15	7894-15	6	42
0789016095100	789MG-9	30	4	15	19	7893-15	7894-15	6	42
0789016105100	789MG-10	30	5	16	19	7893-15	7894-15	6	42
0789016135100	789MG-13	30	6	19	22	7893-18	7894-18	6	42
0789016155100	789MG-15	30	7	22	22	7893-18	7894-18	6	42
0789016165100	789MG-16	30	8	24	22	7893-18	7894-18	6	62
0789016175100	789MG-17	30	9	25	22	7893-18	7894-18	6	62
0789016185100	789MG-18	30	9	26	22	7893-18	7894-18	6	62
0789016195100	789MG-19	30	9,5	27,5	22	7893-18	7894-18	6	62

## 797-E...

### IMPACT SOCKET 3/8"

- for outside TORX® screws
- for power tools
- special steel, phosphated
- female square drive according to DIN 3121-G 10, ISO 1174
- TORX® = reg. trademark of Acument Intellectual Properties, LLC. USA

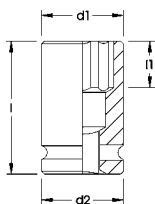

10

3/8"

Code	Number	mm	l/mm	l1 mm	d1 mm	d2 mm	Locking Pin	Locking Ring	Pieces	Weight/g
0797000045000	797-E4	3,86	32	5	9	19	7893-15	7894-15	6	43
0797000055000	797-E5	4,73	32	5	9	19	7893-15	7894-15	6	43
0797000065000	797-E6	5,74	32	7	10	19	7893-15	7894-15	6	42
0797000075000	797-E7	6,16	32	7	10	19	7893-15	7894-15	6	42
0797000085000	797-E8	7,52	32	8	10,5	19	7893-15	7894-15	6	42
0797000105000	797-E10	9,42	32	9	12,5	19	7893-15	7894-15	6	42
0797000125000	797-E12	11,17	32	10	15	19	7893-15	7894-15	6	42
0797000145000	797-E14	12,9	32	12	17,5	19	7893-15	7894-15	6	44
0797000165000	797-E16	14,76	32	12	19	19	7893-15	7894-15	6	42

## 789IN-...

### IMPACT SCREWDRIVER SOCKET 3/8"

- for inside hexagon screws
- for power tools
- with exchangeable blades
- special steel, phosphated
- female square drive according to DIN 3121-G 10, ISO 1174

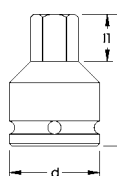

10

3/8"

Code	Number	l/mm	l1 mm	d mm	Locking Pin	Locking Ring	Pieces	Weight/g
0789010305100	789IN-3	48	20	19	7893-15	7894-15	6	35
0789010405100	789IN-4	48	20	19	7893-15	7894-15	6	35
0789010505100	789IN-5	48	20	19	7893-15	7894-15	6	40
0789010605100	789IN-6	48	20	19	7893-15	7894-15	6	40
0789010805100	789IN-8	55	25	19	7893-15	7894-15	6	55
0789011005100	789IN-10	60	28	19	7893-15	7894-15	6	70
0789011205100	789IN-12	65	31	19	7893-15	7894-15	6	90

Spare blades on request

## 7906-...

### IMPACT EXTENSION BAR 3/8"

- for power tools
- special steel, phosphated
- square according to DIN 3121, form F and G, ISO 1174



10

3/8"

Code	Number	l/mm	Locking Pin	Locking Ring	Pieces	Weight/g
7906000755100	7906-75	75	7893-15	7894-15	6	87
7906001505100	7906-150	150	7893-15	7894-15	3	180
7906002505100	7906-250	250	7893-15	7894-15	3	286

You will find the matching socket rails on page no. 136



### 795-3/8

#### IMPACT UNIVERSAL JOINT 3/8"

- for power tools
- special steel, phosphated
- square according to DIN 3121, form F and G, ISO 1174



10

3/8"

Code	Number	l/mm	Locking Pin	Locking Ring	Pieces	Weight/g
0795100195100	795-3/8	50	7893-18	7894-18	3	67

### 7902-.../7905-.../7907-...

#### IMPACT ADAPTOR

- for power tools
- special steel, phosphated
- square according to DIN 3121, form F, G and H, ISO 1174



10

3/8"

Code	Number	Ø	□	l/mm	Locking Pin	Locking Ring	Pieces	Weight/g
7907100195100	7907-3/8	1/4"	3/8"	25	7883-11	7884-11	3	20
7905100235100	7905-1/2	3/8"	1/2"	32	7893-21	7894-20	3	75
7902100195100	7902-3/8	1/2"	3/8"	36	7903-20	7904-20	3	65

### 3426

#### IMPACT ADAPTOR

- for power tools
- with 1/4" outside hexagon according to DIN 3126-E 6,3, DIN ISO 1173
- special steel
- male square drive according to DIN 3121-E 10, ISO 1174, with locking pin
- according to DIN 7428, ISO 3317



10

3/8"

Code	Number	l/mm	□	Ø	Pieces	Weight/g
3426000000000	3426	50	3/8"	1/4"	6	52

### 7893-.../7894-...

#### IMPACT LOCKING PIN AND RING FOR IMPACT SOCKET 3/8"

- for locking impact sockets and operating tools
- locking pin made of alloyed special steel
- locking ring made of rubber elastic and oil resistant material



Code	Number	l/mm	mm Ø	Pieces	Weight/g
7893000155100	7893-15	15	2,5	12	0,60
7893000185100	7893-18	18	2,5	12	0,75
7893000215100	7893-21	21	3,0	12	0,80
7894000155100	7894-15	-	15	12	0,30
7894000185100	7894-18	-	18	12	0,35
7894000205100	7894-20	-	20	12	0,30

**790-..., 790A-....**

**IMPACT SOCKET 1/2", HEXAGON**

- for power tools
- special steel, phosphated
- female square drive according to DIN 3121-G 12,5, ISO1174
- according to DIN 3129, ISO 2725-2

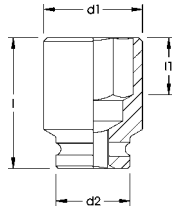

Code	Number	l/mm	l1 mm	d1 mm	d2 mm	Locking Pin	Locking Ring	Pieces	Weight/g
0790000105100	790-10	36	7	17,5	25	7903-20	7904-20	6	90
0790000115100	790-11	36	7	18,5	25	7903-20	7904-20	6	90
0790000125100	790-12	36	8	20	25	7903-20	7904-20	6	95
0790000135100	790-13	36	8	21	25	7903-20	7904-20	6	88
0790000145100	790-14	37	9	22,5	25	7903-20	7904-20	6	90
0790000155100	790-15	37	9	23,5	30	7903-25	7904-24	6	135
0790000165100	790-16	37	10	25	30	7903-25	7904-24	6	135
0790000175100	790-17	37	10	26	30	7903-25	7904-24	6	140
0790000185100	790-18	38	11	27,5	30	7903-25	7904-24	6	137
0790000195100	790-19	38	12	28,5	30	7903-25	7904-24	6	130
0790000205100	790-20	38	12	30	30	7903-25	7904-24	6	130
0790000215100	790-21	39	13	31	30	7903-25	7904-24	6	130
0790000225100	790-22	39	14	32,5	30	7903-25	7904-24	6	150
0790000235100	790-23	39	15	33,5	30	7903-25	7904-24	6	180
0790000245100	790-24	42	16	35	30	7903-25	7904-24	6	185
0790000255100	790-25	42	16	36	30	7903-25	7904-24	6	215
0790000265100	790-26	42	17	37,5	30	7903-25	7904-24	6	225
0790000275100	790-27	45	18	38,5	30	7903-25	7904-24	6	230
0790000285100	790-28	45	18	40	30	7903-25	7904-24	6	255
0790000295100	790-29	45	19	41	30	7903-25	7904-24	6	245
0790000305100	790-30	49	20	42,5	30	7903-25	7904-24	6	250
0790000325100	790-32	49	21	45	30	7903-25	7904-24	6	250
0790000345100	790-34	51	22	47,5	30	7903-25	7904-24	6	275



Code	Number	l/mm	l1 mm	d1 mm	d2 mm	Locking Pin	Locking Ring	Pieces	Weight/g
0790100195100	790A-3/8	35	5	16,5	25	7903-20	7904-20	6	90
0790100215100	790A-7/16	35	7	18	25	7903-20	7904-20	6	90
0790100235100	790A-1/2	35	7	20	25	7903-20	7904-20	6	88
0790100245100	790A-9/16	35	8	22	25	7903-20	7904-20	6	135
0790100265100	790A-5/8	35	9	24	30	7903-25	7904-24	6	135
0790100275100	790A-11/16	35	10	26	30	7903-25	7904-24	6	137
0790100285100	790A-3/4	35	11	29	30	7903-25	7904-24	6	130
0790100305100	790A-13/16	38	13	31	30	7903-25	7904-24	6	130
0790100315100	790A-7/8	38	14	33	30	7903-25	7904-24	6	150
0790100325100	790A-15/16	38	15	35	36	7903-30	7904-30	6	185
0790100345100	790A-1	38	16	37	36	7903-30	7904-30	6	225
0790100355100	790A-1. 1/16	40	16	39	36	7903-30	7904-30	6	225
0790100365100	790A-1.1/8	50	18	41	36	7903-30	7904-30	6	255
0790100385100	790A-1 1/4	50	19	44	36	7903-30	7904-30	6	250
0790100395100	790A-1.5/16	50	20	46	36	7903-30	7904-30	6	290



## 790LT-...

### IMPACT SOCKET 1/2", EXTRA DEEP, HEXAGON

- for power tools
- special steel, phosphated
- female square drive according to DIN 3121-G 12,5, ISO 1174
- inch sizes on request resp. see price list

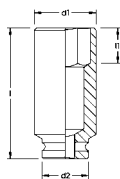

Code	Number	l/mm	l1 mm	d1 mm	d2 mm	Locking Pin	Locking Ring	Pieces	Weight/g
0790020105100	790LT-10	85	12	17	25	7903-20	7904-20	6	155
0790020135100	790LT-13	85	14	21	25	7903-20	7904-20	6	160
0790020145100	790LT-14	85	15	22,5	25	7903-20	7904-20	6	185
0790020165100	790LT-16	85	15	25	30	7903-25	7904-24	6	210
0790020175100	790LT-17	85	15	26	30	7903-25	7904-24	6	230
0790020185100	790LT-18	85	16	27	30	7903-25	7904-24	6	240
0790020195100	790LT-19	85	16	28,5	30	7903-25	7904-24	3	250
0790020205100	790LT-20	85	19	30	30	7903-25	7904-24	3	260
0790020215100	790LT-21	85	19	31	30	7903-25	7904-24	3	275
0790020225100	790LT-22	85	19	32,5	30	7903-25	7904-24	3	300
0790020245100	790LT-24	85	21	35	30	7903-25	7904-24	3	370
0790020275100	790LT-27	85	23	38	30	7903-25	7904-24	3	430
0790020305100	790LT-30	85	25	42	30	7903-25	7904-24	3	510
0790020325100	790LT-32	85	25	44	30	7903-25	7904-24	3	560

## 790MG-...

### IMPACT SOCKET 1/2", WITH MAGNETIC INSERT, HEXAGON

- for power tools
- special steel, gunmetal-finish
- female square drive according to DIN 3121-G 12,5, ISO 1174
- according to DIN 3129, ISO 2725-2

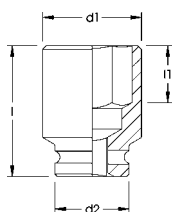

Code	Number	l/mm	l1 mm	d1 mm	d2 mm	Locking Pin	Locking Ring	Pieces	Weight/g
0790016105100	790MG-10	38	5	17	25	7903-20	7904-20	6	92
0790016115100	790MG-11	38	5	19	25	7903-20	7904-20	6	92
0790016125100	790MG-12	38	6	20	25	7903-20	7904-20	6	92
0790016135100	790MG-13	38	6	21	25	7903-20	7904-20	6	92
0790016145100	790MG-14	38	7	22,5	25	7903-20	7904-20	6	92
0790016155100	790MG-15	38	7	23,7	30	7903-25	7904-24	6	132
0790016165100	790MG-16	38	8	25	30	7903-25	7904-24	6	132
0790016175100	790MG-17	38	9	26	30	7903-25	7904-24	6	132
0790016185100	790MG-18	38	9	27,5	30	7903-25	7904-24	6	132
0790016195100	790MG-19	38	9,5	28,7	30	7903-25	7904-24	6	132

## 798-E...

### IMPACT SOCKET 1/2"

- for outside TORX® screws
- for power tools
- special steel, phosphated
- female square according to DIN 3121-G 12,5, ISO 1174
- TORX® = reg. trademark of Acument Intellectual Properties, LLC. USA

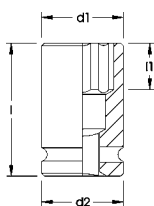

12,5

1/2"

Code	Number	mm	l/mm	l1 mm	d1 mm	d2 mm	Locking Pin	Locking Ring	Pieces	Weight/g
0798000105000	798-E10	9,42	38	9	15	25	7903-20	7904-20	6	84
0798000125000	798-E12	11,17	38	10	16	25	7903-20	7904-20	6	85
0798000145000	798-E14	12,90	38	12	18,5	25	7903-20	7904-20	6	86
0798000185000	798-E18	16,70	38	12	22	25	7903-20	7904-20	6	90
0798000205000	798-E20	18,45	38	13	25	30	7903-25	7904-24	6	128
0798000245000	798-E24	22,16	38	17	28,5	30	7903-25	7904-24	6	142

## 790IN-..., 790INA-...

### IMPACT SCREWDRIVER SOCKET 1/2"

- for inside hexagon screws
- with exchangeable blades
- for power tools
- special steel, phosphated
- female square drive according to DIN 3121-G 12,5, ISO 1174

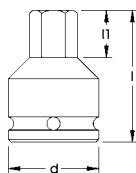

12,5

1/2"

Code	Number	l/mm	l1 mm	d mm	Locking Pin	Locking Ring	Pieces	Weight/g
0790010505100	790IN-5	54	8	25	7903-20	7904-20	6	90
0790010605100	790IN-6	54	9	25	7903-20	7904-20	6	100
0790010805100	790IN-8	57	12	25	7903-20	7904-20	6	100
0790011005100	790IN-10	57	16	25	7903-20	7904-20	6	100
0790011205100	790IN-12	57	18	30	7903-25	7904-24	6	150
0790011405100	790IN-14	57	21	30	7903-25	7904-24	6	150
0790011705100	790IN-17	57	26	30	7903-25	7904-24	6	150
0790011905100	790IN-19	72	26	30	7903-25	7904-24	6	150



Code	Number	l/mm	l1 mm	d mm	Locking Pin	Locking Ring	Pieces	Weight/g
0790110065100	790INA-1/8	54	6	25	7903-20	7904-20	6	90
0790110085100	790INA-5/32	54	6	25	7903-20	7904-20	6	90
0790110095100	790INA-3/16	54	8	25	7903-20	7904-20	6	90
0790110115100	790INA-7/32	54	9	25	7903-20	7904-20	6	90
0790110135100	790INA-1/4	57	12	25	7903-20	7904-20	6	100
0790110175100	790INA-5/16	57	12	25	7903-20	7904-20	6	100
0790110195100	790INA-3/8	57	16	25	7903-20	7904-20	6	100
0790110215100	790INA-7/16	57	18	25	7903-20	7904-20	6	100
0790110235100	790INA-1/2	57	19	30	7903-25	7904-24	6	150
0790110245100	790INA-9/16	57	21	30	7903-25	7904-24	6	150
0790110265100	790INA-5/8	57	24	30	7903-25	7904-24	6	150

Spare blades on request

### 790TX-... IMPACT SCREWDRIVER SOCKET 1/2"

- ▶ for inside TORX® screws
- ▶ exchangeable blades
- ▶ for power tools
- ▶ special steel, gunmetal-finish
- ▶ female square drive according to DIN 3121-G 12,5, ISO 1174
- ▶ TORX® = reg. trademark of Acument Intellectual Properties, LLC. USA

12,5

1/2"

Code	Number	mm	l/mm ┌──┐	l1 mm	d mm	Locking Pin	Locking Ring	Pieces ☞	Weight/g ⚖
0790015305100	790TX-30	5,52	57	3,19	25	7903-20	7904-20	6	110
0790015405100	790TX-40	6,65	57	3,30	25	7903-20	7904-20	6	110
0790015505100	790TX-50	8,83	57	4,57	25	7903-20	7904-20	6	110
0790015555100	790TX-55	11,22	57	5,08	25	7903-20	7904-20	6	110
0790015605100	790TX-60	13,25	60	7,62	30	7903-25	7904-24	6	170
0790015705100	790TX-70	15,53	70	8,89	30	7903-25	7904-24	6	180

Spare blades on request

04

### 7901-... IMPACT EXTENSION BAR 1/2"

- ▶ for power tools
- ▶ special steel, phosphated
- ▶ female square according to DIN 3121, form F and G, ISO 1174

12,5

1/2"

Code	Number	l/mm ┌──┐	Locking Pin	Locking Ring	Pieces ☞	Weight/g ⚖
7901001255100	7901-125	125	7903-20	7904-20	3	270
7901002505100	7901-250	250	7903-20	7904-20	3	540

### 795-1/2 IMPACT UNIVERSAL JOINT 1/2"

- ▶ for power tools
- ▶ special steel, phosphated
- ▶ female square according to DIN 3121, form F and G, ISO 1174

12,5

1/2"

Code	Number	l/mm ┌──┐	Locking Pin	Locking Ring	Pieces ☞	Weight/g ⚖
0795100235100	795-1/2	65	7903-25	7904-24	3	170

**You will find the matching socket rails on page no. 154**

## 7902-.../7912-...

### IMPACT ADAPTOR

- ▶ for power tools
- ▶ special steel, phosphated
- ▶ square according to DIN 3121, form F, G and H, ISO 1174



12,5

1/2"

Code	Number	□	■	l/mm	Locking Pin	Locking Ring	Pieces	Weight/g
7905100235100	7905-1/2	3/8"	1/2"	32	7893-21	7894-20	3	75
7902100195100	7902-3/8	1/2"	3/8"	36	7903-20	7904-20	3	65
7902100285100	7902-3/4	1/2"	3/4"	50	7903-25	7904-24	3	162
7912100235100	7912-1/2	3/4"	1/2"	57	7913-29	7914-28	3	235

## 3427

### IMPACT ADAPTOR

- ▶ for power tools
- ▶ with 1/4" outside hexagon according to DIN 3126-E 6,3, ISO 1173
- ▶ special steel
- ▶ male square drive according to DIN 3121-E 12,5, DIN ISO 1174, with locking pin
- ▶ according to DIN 7428, ISO 3317



12,5

1/2"

Code	Number	l/mm	□	●	Pieces	Weight/g
3427000000000	3427	75	1/2"	1/4"	6	100

## 7903-.../7904-...

### IMPACT LOCKING PIN AND RING FOR IMPACT SOCKETS 1/2"

- ▶ for locking impact sockets and operating tools
- ▶ locking pin made of alloyed special steel
- ▶ locking ring made of rubber elastic and oil resistant material



Code	Number	l/mm	mm Ø	Pieces	Weight/g
7903000205100	7903-20	20	3,0	12	0,75
7903000255100	7903-25	25	3,0	12	0,80
7903000305100	7903-30	30	3,0	12	1,00
7904000205100	7904-20	-	20	12	0,50
7904000245100	7904-24	-	24	12	1,00
7904000305100	7904-30	-	30	12	1,50



### 790S6... IMPACT SOCKET SET 1/2"

- for power tools
- in black metal storage case with OMS-hard foam insert
- tools made of special steel, phosphated
- square according to DIN 3121, form F and G, ISO1174



 12,5  
 1/2"  
 mm  
 AF"

Code	Number	Contents	Pieces	Weight/g
0790500605100	790 S6	Impact Sockets 1/2"; 790- 10, 13, 17, 19, 24 mm Impact Extension Bar 1/2"; 7901-125	1	1200
0790600605100	790 S6A	Impact Sockets 1/2"; 790A- 3/8, 1/2, 7/8, 3/4, 15/16" AF Impact Extension Bar 1/2"; 7901-125	1	1200

### 790 S6LT IMPACT SOCKET SET 1/2"

- for power tools
- in black metal storage case with OMS-hard foam insert
- square according to DIN 3121, form F and G, ISO1174
- tools made of special steel, phosphated



 12,5  
 1/2"  
 mm

Code	Number	Contents	Pieces	Weight/g
0790520605100	790 S6LT	Impact Sockets, extra deep 1/2"; 790LT- 10, 13, 17, 19, 24 mm Impact Extension Bar 1/2"; 7901-125	1	1880

### 790 S12... IMPACT SOCKET SET 1/2"

- for power tools
- in black metal storage case with OMS-hard foam insert
- square according to DIN 3121, form F and G, ISO1174
- tools made of special steel, phosphated



 12,5  
 1/2"  
 mm  
 AF"

Code	Number	Contents	Pieces	Weight/g
0790501205100	790 S12	Impact Sockets, 1/2"; 790- 10, 11, 13, 14, 17, 19, 21, 22, 23, 24 mm Impact Extension Bar 1/2", 7901-125 Impact Universal Joint 1/2", 795-1/2	1	2400
0790601205100	790 S12A	Impact Sockets, 1/2"; 790A- 3/8, 7/16, 1/2, 9/16, 5/8, 11/16, 3/4, 7/8, 15/16, 1" AF Impact Extension Bar 1/2", 7901-125 Impact Universal Joint 1/2", 795-1/2	1	2400

**You will find the matching OMS-24 module on page no. 47**



**791-..., 791A-...**

**IMPACT SOCKET 3/4", HEXAGON**

- for power tools
- special steel, phosphated
- female square drive according to DIN 3121-H 20, ISO 1174
- according to DIN 3129, ISO 2725-2

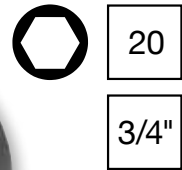
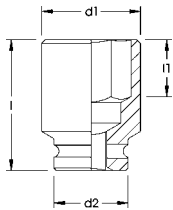

Code	Number	l/mm	l1 mm	d1 mm	d2 mm	Locking Pin	Locking Ring	Pieces	Weight/g
0791000175100	791-17	50	10	30	44	7913-37	7914-36	3	365
0791000195100	791-19	50	12	32,5	44	7913-37	7914-36	3	370
0791000215100	791-21	51	13	35	44	7913-37	7914-36	3	380
0791000225100	791-22	51	14	37,5	44	7913-37	7914-36	3	395
0791000245100	791-24	52	16	39	44	7913-37	7914-36	3	380
0791000255100	791-25	52	16	40	44	7913-37	7914-36	3	380
0791000265100	791-26	53	17	41,5	44	7913-37	7914-36	3	370
0791000275100	791-27	53	18	42,5	44	7913-37	7914-36	3	385
0791000285100	791-28	53	18	44	44	7913-37	7914-36	3	390
0791000295100	791-29	53	19	45	44	7913-37	7914-36	3	390
0791000305100	791-30	53	20	46,5	44	7913-37	7914-36	3	390
0791000325100	791-32	56	21	49	44	7913-37	7914-36	1	450
0791000335100	791-33	56	21	50	44	7913-37	7914-36	1	470
0791000345100	791-34	56	22	51,5	44	7913-37	7914-36	1	480
0791000365100	791-36	56	24	54	44	7913-37	7914-36	1	495
0791000385100	791-38	56	25	56,5	44	7913-37	7914-36	1	550
0791000415100	791-41	57	26	60	44	7913-37	7914-36	1	560
0791000465100	791-46	62	28	66,5	44	7913-37	7914-36	1	720



Code	Number	l/mm	l1 mm	d1 mm	d2 mm	Locking Pin	Locking Ring	Pieces	Weight/g
0791100285100	791A-3/4	50	12	31,5	44	7913-37	7914-36	3	370
0791100305100	791A-13/16	50	14	34	44	7913-37	7914-36	3	380
0791100315100	791A-7/8	50	16	36	44	7913-37	7914-36	3	395
0791100325100	791A-15/16	50	16	38	44	7913-37	7914-36	3	380
0791100345100	791A-1	53	18	40	44	7913-37	7914-36	3	380
0791100355100	791A-1.1/16	53	18	42	44	7913-37	7914-36	3	385
0791100365100	791A-1.1/8	53	20	44	44	7913-37	7914-36	3	390
0791100375100	791A-1.3/16	53	20	46	44	7913-37	7914-36	3	390
0791100385100	791A-1.1/4	56	20	48	44	7913-37	7914-36	1	450
0791100395100	791A-1.5/16	56	23	50	44	7913-37	7914-36	1	470
0791100405100	791A-1.3/8	56	23	52	44	7913-37	7914-36	1	480
0791100415100	791A-1.7/16	56	23	54	44	7913-37	7914-36	1	495
0791100425100	791A-1.1/2	56	25	56	44	7913-37	7914-36	1	530
0791100445100	791A-1.5/8	57	25	59	44	7913-37	7914-36	1	560
0791110455100	791A-1.11/16	57	29	63,5	44	7913-37	7914-36	1	720
0791110465100	791A-1.3/4	57	29	65	54	7913-45	7914-46	1	850
0791110485100	791A-1.7/8	62	29	68	54	7913-45	7914-46	1	950
0791110495100	791A-2	65	29	72	54	7913-45	7914-46	1	1040

## 791LT-...

### IMPACT SOCKET 3/4", EXTRA DEEP, HEXAGON

- for power tools
- special steel, phosphated
- female square drive according to DIN 3121-H 20, ISO 1174
- inch sizes on request resp. see price list

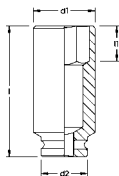

20

3/4"



Code	Number	l/mm	l1 mm	d1 mm	d2 mm	Locking Pin	Locking Ring	Pieces	Weight/g
0791020175100	791LT-17	100	15	30	44	7913-37	7914-36	1	565
0791020195100	791LT-19	100	17	32,5	44	7913-37	7914-36	1	650
0791020225100	791LT-22	100	19	36,5	44	7913-37	7914-36	1	650
0791020245100	791LT-24	100	21	39	44	7913-37	7914-36	1	685
0791020275100	791LT-27	100	23	42,5	44	7913-37	7914-36	1	780
0791020305100	791LT-30	100	25	46,5	44	7913-37	7914-36	1	825
0791020325100	791LT-32	100	26	49	44	7913-37	7914-36	1	860
0791020335100	791LT-33	100	26	50	44	7913-37	7914-36	1	915
0791020345100	791LT-34	100	27	51,5	44	7913-37	7914-36	1	925
0791020365100	791LT-36	100	29	54	44	7913-37	7914-36	1	940
0791020385100	791LT-38	100	30	56,5	44	7913-37	7914-36	1	960
0791020415100	791LT-41	100	31	60	44	7913-37	7914-36	1	1120
0791020465100	791LT-46	100	33	66,5	44	7913-37	7914-36	1	1440
0791020505100	791LT-50	100	36	71,5	44	7913-37	7914-36	1	1630
0791020555100	791LT-55	100	38	77,5	44	7913-37	7914-36	1	1840
0791020605100	791LT-60	100	41	84	44	7913-37	7914-36	1	2060
0791020655100	791LT-65	100	41	90	44	7913-37	7914-36	1	2320

## 791IN-..., 791INA-...

### IMPACT SOCKET 3/4"

- for power tools
- for inside hexagon screws
- with exchangeable blades
- special steel, phosphated
- female square according to DIN 3121-H 20, ISO 1174

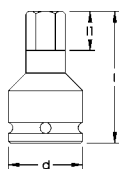

20

3/4"



Code	Number	l/mm	l1 mm	d mm	Locking Pin	Locking Ring	Pieces	Weight/g
0791010105100	791IN-10	69	16	38	7913-37	7914-36	3	310
0791010125100	791IN-12	69	18	38	7913-37	7914-36	3	310
0791010145100	791IN-14	69	21	38	7913-37	7914-36	3	310
0791010175100	791IN-17	69	26	38	7913-37	7914-36	3	310
0791010195100	791IN-19	84	26	44	7913-37	7914-36	3	630
0791010225100	791IN-22	84	26	44	7913-37	7914-36	3	630
0791010245100	791IN-24	84	26	44	7913-37	7914-36	3	630



Code	Number	l/mm	l1 mm	d mm	Locking Pin	Locking Ring	Pieces	Weight/g
0791110195100	791INA-3/8	72	16	38	7913-29	7914-28	3	310
0791110215100	791INA-7/16	72	18	38	7913-29	7914-28	3	310
0791110235100	791INA-1/2	72	19	38	7913-29	7914-28	3	310
0791110245100	791INA-9/16	72	21	38	7913-29	7914-28	3	310
0791110265100	791INA-5/8	74	24	38	7913-29	7914-28	3	310
0791110285100	791INA-3/4	84	26	44	7913-37	7914-36	3	630
0791110305100	791INA-13/16	84	26	44	7913-37	7914-36	3	630
0791110315100	791INA-7/8	84	26	44	7913-37	7914-36	3	630
0791110345100	791INA-1	91	30	44	7913-37	7914-36	3	630

**7911-...**  
**IMPACT EXTENSION BAR 3/4"**

- ▶ for power tools
- ▶ special steel, phosphated
- ▶ square drive according to DIN 3121, form F and H, ISO 1174



20

3/4"

Code	Number	l/mm	Locking Pin	Locking Ring	Pieces	Weight/g
7911001755100	7911-175	175	7913-37	7914-36	1	810
7911002505100	7911-250	250	7913-37	7914-36	1	1105
7911003255100	7911-325	325	7913-37	7914-36	1	1320

**795-3/4**  
**IMPACT UNIVERSAL JOINT 3/4"**

- ▶ for power tools
- ▶ special steel, phosphated
- ▶ square drive according to DIN 3121, Form F and H, ISO 1174



20

3/4"

Code	Number	l/mm	Locking Pin	Locking Ring	Pieces	Weight/g
0795100285100	795-3/4	105	7913-37	7914-36	1	700

**7902-.../7912-.../7922-...**  
**IMPACT ADAPTOR**

- ▶ for power tools
- ▶ special steel, phosphated
- ▶ square according to DIN 3121, form F, G and H, ISO 1174



20

3/4"

Code	Number	⊘	■	l/mm	Locking Pin	Locking Ring	Pieces	Weight/g
7902100285100	7902-3/4	1/2"	3/4"	50	7903-25	7904-24	3	162
7912100235100	7912-1/2	3/4"	1/2"	57	7913-37	7914-36	3	235
7912100345100	7912-1	3/4"	1"	62	7913-37	7914-36	3	340
7922100285100	7922-3/4	1"	3/4"	75	7923-42	7924-41	1	530

**7913-.../7914-...**  
**IMPACT LOCKING PIN AND RING FOR IMPACT SOCKET 3/4"**

- ▶ for locking impact sockets and operating tools
- ▶ locking pin made of alloyed special steel
- ▶ locking ring made of rubber elastic and oil resistant material



7913-...
7914-...

Code	Number	l/mm	mm Ø	Pieces	Weight/g
7913000295100	7913-29	29	4,0	12	3,0
7913000375100	7913-37	37	4,0	12	3,8
7913000455100	7913-45	45	4,0	12	4,5
7914000285100	7914-28	-	28	12	1,2
7914000365100	7914-36	-	36	12	1,4
7914000465100	7914-46	-	46	12	1,6



### 791 S6LT

#### IMPACT SOCKET SET 3/4"

- ▶ for power tools
- ▶ in black metal storage case with OMS-hard foam insert
- ▶ female square drive according to DIN 3121-H 20, ISO1174
- ▶ tools made of special steel, phosphated





20



3/4"



mm



AF"

Code	Number	Contents	Pieces	Weight/g
0791520605100	791 S6LT	Impact Sockets, extra deep 3/4"; 791LT- 24, 27, 30, 32, 36, 41 mm	1	7120

### 791 S5...

#### IMPACT SOCKET SET 3/4"

- ▶ for power tools
- ▶ in black metal storage case with OMS-hard foam insert
- ▶ female square drive according to DIN 3121-H 20, ISO 1174
- ▶ tools made of special steel, phosphated





20



3/4"



mm



AF"

Code	Number	Contents	Pieces	Weight/g
0791500505100	791 S5	Impact Sockets 3/4"; 791- 19, 24, 27, 30, 32 mm	1	2800
0791600505100	791 S5A	Impact Sockets 3/4"; 791A- 3/4, 15/16, 1.1/16, 1-3/16, 1.5/16" AF	1	2800

### 791 S10...

#### IMPACT SOCKET SET 3/4"

- ▶ for power tools
- ▶ in black metal storage case with OMS-hard foam insert
- ▶ female square drive according to DIN 3121-H 20, ISO1174
- ▶ tools made of special steel, phosphated





20



3/4"



mm



AF"

Code	Number	Contents	Pieces	Weight/g
0791501005100	791 S10	Impact Sockets 3/4": 791- 17, 19, 22, 24, 27, 30, 32, 36, 41, 46 mm	1	6160
0791601005100	791 S10A	Impact Sockets 3/4": 791- 3/4, 7/8, 15/16, 1.1/16, 1.3/16, 1.5/16, 1.7/16, 1.5/8, 1.3/4, 1.7/8" AF	1	6160

**You will find the matching OMS-24 module on page no. 47**



**792-..., 792A-...**

**IMPACT SOCKET 1", HEXAGON**

- for power tools
- special steel, phosphated
- female square drive according to DIN 3121-H 25, ISO 1174
- according to DIN 3129, ISO 2725-2

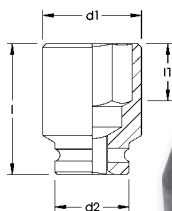

25

1"



Code	Number	l/mm	l1 mm	d1 mm	d2 mm	Locking Pin	Locking Ring	Pieces	Weight/g
0792000195100	792-19	56	12	35,5	54	7923-45	7924-44	1	650
0792000215100	792-21	56	13	38	54	7923-45	7924-44	1	650
0792000225100	792-22	56	14	39,5	54	7923-45	7924-44	1	650
0792000245100	792-24	57	16	42	54	7923-45	7924-44	1	665
0792000255100	792-25	58	17	43	54	7923-45	7924-44	1	660
0792000265100	792-26	58	17	44,5	54	7923-45	7924-44	1	655
0792000275100	792-27	59	18	45,5	54	7923-45	7924-44	1	655
0792000285100	792-28	58	19	46	54	7923-45	7924-44	1	655
0792000295100	792-29	60	19	48	54	7923-45	7924-44	1	660
0792000305100	792-30	61	20	49,5	54	7923-45	7924-44	1	660
0792000325100	792-32	61	21	52	54	7923-45	7924-44	1	660
0792000335100	792-33	61	21	53	54	7923-45	7924-44	1	650
0792000345100	792-34	62	22	54,5	54	7923-45	7924-44	1	650
0792000365100	792-36	64	24	57	54	7923-45	7924-44	1	710
0792000385100	792-38	64	25	59,5	54	7923-45	7924-44	1	730
0792000415100	792-41	68	26	63	54	7923-45	7924-44	1	765
0792000425100	792-42	68	26	64,5	54	7923-45	7924-44	1	795
0792000465100	792-46	72	28	69,5	54	7923-45	7924-44	1	1025
0792000505100	792-50	76	31	74,5	54	7923-45	7924-44	1	1150
0792000525100	792-52	76	31	76	54	7923-45	7924-44	1	1170
0792000555100	792-55	80	33	80,5	54	7923-45	7924-44	1	1385
0792000605100	792-60	85	36	87	54	7923-45	7924-44	1	1660
0792000655100	792-65	90	39	93	54	7923-45	7924-44	1	1970
0792000705100	792-70	95	41	99,5	54	7923-45	7924-44	1	2280



Code	Number	l/mm	l1 mm	d1 mm	d2 mm	Locking Pin	Locking Ring	Pieces	Weight/g
0792100285100	792A-3/4	55	9,5	35	54	7923-45	7924-44	1	600
0792100325100	792A-15/16	55	13	41	54	7923-45	7924-44	1	600
0792100345100	792A-1	55	13	43	54	7923-45	7924-44	1	600
0792100365100	792A-1.1/8	57	16,5	48	54	7923-45	7924-44	1	630
0792100385100	792A-1.1/4	57	17	51	54	7923-45	7924-44	1	630
0792100395100	792A-1.5/16	60	19	54	54	7923-45	7924-44	1	650
0792100405100	792A-1.3/8	60	19	54	54	7923-45	7924-44	1	650
0792100415100	792A-1.7/16	60	19	54	54	7923-45	7924-44	1	650
0792100425100	792A-1.1/2	64	22	60	54	7923-45	7924-44	1	760
0792100445100	792A-1.5/8	64	22	63	54	7923-45	7924-44	1	800
0792100475100	792A-1.13/16	69	25,5	70	54	7923-45	7924-44	1	1000
0792100485100	792A-1.7/8	72	27	70	54	7923-45	7924-44	1	1000
0792100495100	792A-2	72	27	73	54	7923-45	7924-44	1	1080
0792100525100	792A-2.3/16	80	32	82	54	7923-45	7924-44	1	1400
0792100535100	792A-2.1/4	80	33	82	54	7923-45	7924-44	1	1400

## 792LT-...

### IMPACT SOCKET 1", EXTRA DEEP, HEXAGON

- for power tools
- special steel, phosphated
- female square drive according to DIN 3121-H 25, ISO 1174
- inch sizes on request resp. see price list

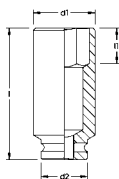

25

1"



Code	Number	l/mm	l1 mm	d1 mm	d2 mm	Locking Pin	Locking Ring	Pieces	Weight/g
0792020215100	792LT-21	110	18	38	54	7923-45	7924-44	1	960
0792020225100	792LT-22	110	19	39,5	54	7923-45	7924-44	1	960
0792020245100	792LT-24	110	21	42	54	7923-45	7924-44	1	970
0792020275100	792LT-27	110	23	45,5	54	7923-45	7924-44	1	1015
0792020305100	792LT-30	110	25	49,5	54	7923-45	7924-44	1	1095
0792020325100	792LT-32	110	26	52	54	7923-45	7924-44	1	1165
0792020335100	792LT-33	110	26	53	54	7923-45	7924-44	1	1160
0792020345100	792LT-34	110	27	54,5	54	7923-45	7924-44	1	1200
0792020365100	792LT-36	110	29	57	54	7923-45	7924-44	1	1250
0792020385100	792LT-38	110	30	59,5	54	7923-45	7924-44	1	1350
0792020415100	792LT-41	110	31	63	54	7923-45	7924-44	1	1430
0792020465100	792LT-46	110	33	69,5	54	7923-45	7924-44	1	1770
0792020505100	792LT-50	110	36	74,5	54	7923-45	7924-44	1	1935
0792020555100	792LT-55	110	38	80,5	54	7923-45	7924-44	1	2000
0792020605100	792LT-60	110	41	87	54	7923-45	7924-44	1	2540
0792020655100	792LT-65	110	44	93	54	7923-45	7924-44	1	2750
0792020705100	792LT-70	110	46	99,5	54	7923-45	7924-44	1	3000
0792020755100	792LT-75	120	48	105,5	86	7933-75	7934-75	1	4790
0792020805100	792LT-80	125	51	112	86	7933-75	7934-75	1	5390
0792020855100	792LT-85	130	54	118	86	7933-75	7934-75	1	5990
0792020905100	792LT-90	135	57	124,5	86	7933-75	7934-75	1	6700
0792020955100	792LT-95	140	60	130,5	86	7933-75	7934-75	1	7410
0792021005100	792LT-100	140	63	137	86	7933-75	7934-75	1	7860

04

## 792IN-..., 792INA-...

### IMPACT SOCKET 1"

- for power tools
- for inside hexagon screws
- with exchangeable blades
- special steel, phosphated
- female square drive according to DIN 3121-H 25, ISO 1174

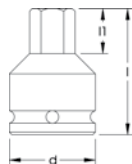

25

1"



Code	Number	l/mm	l1 mm	d mm	Locking Pin	Locking Ring	Pieces	Weight/g
0792010105100	792IN-10	82	16	54	7923-45	7924-45	1	800
0792010125100	792IN-12	82	21	54	7923-45	7924-45	1	800
0792010145100	792IN-14	82	21	54	7923-45	7924-45	1	800
0792010175100	792IN-17	89	26	54	7923-45	7924-45	1	800
0792010195100	792IN-19	89	26	54	7923-45	7924-45	1	900
0792010225100	792IN-22	89	26	54	7923-45	7924-45	1	900
0792010245100	792IN-24	89	26	54	7923-45	7924-45	1	900
0792010275100	792IN-27	95	32	54	7923-45	7924-45	1	1000
0792010305100	792IN-30	100	38	54	7923-45	7924-45	1	1000
0792010325100	792IN-32	100	38	54	7923-45	7924-45	1	1000



Code	Number	l/mm	l1 mm	d mm	Locking Pin	Locking Ring	Pieces	Weight/g
0792110235100	792INA-1/2	82	19	54	7923-45	7924-45	1	800
0792110245100	792INA-9/16	82	21	54	7923-45	7924-45	1	800
0792110265100	792INA-5/8	84	24	54	7923-45	7924-45	1	800
0792110285100	792INA-3/4	89	26	54	7923-45	7924-45	1	800
0792110305100	792INA-13/16	89	26	54	7923-45	7924-45	1	800
0792110315100	792INA-7/8	95	26	54	7923-45	7924-45	1	800
0792110345100	792INA-1	95	30	54	7923-45	7924-45	1	1000
0792110355100	792INA-1.1/16	95	32	54	7923-45	7924-45	1	1000
0792110365100	792INA-1.1/8	95	36	54	7923-45	7924-45	1	1000
0792110375100	792INA-1.3/16	100	36	54	7923-45	7924-45	1	1000
0792110385100	792INA-1.1/4	100	38	54	7923-45	7924-45	1	1000

## 7921-...

### IMPACT EXTENSION BAR 1"

- for power tools
- special steel, phosphated
- square according to DIN 3121, form F and H, ISO 1174



25

1"

Code	Number	l/mm	Locking Pin	Locking Ring	Pieces	Weight/g
7921001755100	7921-175	175	7923-45	7924-44	1	1430
7921002505100	7921-250	250	7923-45	7924-44	1	1900
7921003255100	7921-325	325	7923-45	7924-44	1	2500



**795-1**  
**IMPACT UNIVERSAL JOINT 1"**

- ▶ for power tools
- ▶ special steel, phosphated
- ▶ square according to DIN 3121, form F and H, ISO 1174



25

1"

Code	Number	l/mm	Locking Pin	Locking Ring	Pieces	Weight/g
0795100345100	795-1	128	7923-51	7924-51	1	1675

**7912-.../7922-.../7932-...**  
**IMPACT ADAPTOR**

- ▶ for power tools
- ▶ special steel, phosphated
- ▶ square according to DIN 3121, form F and H, ISO 1174



25

1"

Code	Number	Ø	□	l/mm	Locking Pin	Locking Ring	Pieces	Weight/g
7912100345100	7912-1	3/4"	1"	62	7913-37	7914-36	3	340
7922100285100	7922-3/4	1"	3/4"	75	7923-42	7924-41	1	530
7922100425100	7922-1.1/2	1"	1.1/2"	80	7923-45	7924-44	1	850
7932100345100	7932-1	1.1/2"	1"	95	7933-67	7934-67	1	1890

**7923-.../7924-...**  
**IMPACT LOCKING PIN AND RING FOR IMPACT SOCKET 1"**

- ▶ for locking impact sockets and operating tools
- ▶ locking pin made of alloyed special steel
- ▶ locking ring made of rubber elastic and oil resistant material



Code	Number	l/mm	mm Ø	Pieces	Weight/g
7923000425100	7923-42	42	5,0	12	6,5
7923000455100	7923-45	45	5,0	12	7,0
7923000515100	7923-51	51	5,0	12	8,0
7924000415100	7924-41	-	41	12	4,0
7924000445100	7924-44	-	44	12	5,0
7924000455100	7924-45	-	45	12	5,5
7924000515100	7924-51	-	51	12	6,0

**793-..., 793A-...**

**IMPACT SOCKET 1.1/2", HEXAGON**

- for power tools
- special steel, phosphated
- female square drive according to DIN 3121-H 40, ISO1174
- according to DIN 3129, ISO 2725-2

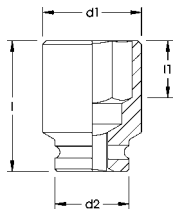

40

1.1/2"

mm

Code	Number	l/mm	l1 mm	d1 mm	d2 mm	Locking Pin	Locking Ring	Pieces	Weight/g
0793000365100	793-36	80	19	64	86	7933-75	7934-75	1	2200
0793000415100	793-41	80	22	70	86	7933-75	7934-75	1	2200
0793000465100	793-46	80	25,5	75	86	7933-75	7934-75	1	2200
0793000505100	793-50	82	27	80	86	7933-75	7934-75	1	2300
0793000555100	793-55	89	30	86	86	7933-75	7934-75	1	2500
0793000605100	793-60	92	33	92	86	7933-75	7934-75	1	2800
0793000655100	793-65	96	35	100	86	7933-75	7934-75	1	3350
0793000705100	793-70	101	38	105	86	7933-75	7934-75	1	3600
0793000755100	793-75	105	41	109	86	7933-75	7934-75	1	3900
0793000805100	793-80	110	44	115	86	7933-75	7934-75	1	4500
0793000855100	793-85	116	47	121	86	7933-75	7934-75	1	5100
0793000905100	793-90	118	49	130	86	7933-75	7934-75	1	5600
0793000955100	793-95	118	49	135	127	7933-116	7934-116	1	7900
0793001005100	793-100	125	54	140	127	7933-116	7934-116	1	8500
0793001055100	793-105	125	54	150	127	7933-116	7934-116	1	9500
0793001105100	793-110	137	62	155	127	7933-116	7934-116	1	10400
0793001155100	793-115	137	67	160	127	7933-116	7934-116	1	11500
0793001205100	793-120	145	67	165	127	7933-116	7934-116	1	12000
0793001255100	793-125	145	67	180	127	7933-116	7934-116	1	12200

AF

Code	Number	l/mm	l1 mm	d1 mm	d2 mm	Locking Pin	Locking Ring	Pieces	Weight/g
0793100395100	793A-1.5/16	75	19	60	86	7933-75	7934-75	1	1800
0793100405100	793A-1.3/8	75	19	60	86	7933-75	7934-75	1	1800
0793100415100	793A-1.7/16	80	19	64	86	7933-75	7934-75	1	2200
0793100425100	793A-1.1/2	80	22	64	86	7933-75	7934-75	1	2200
0793100435100	793A-1.9/16	80	22	70	86	7933-75	7934-75	1	2200
0793100445100	793A-1.5/8	80	22	70	86	7933-75	7934-75	1	2200
0793100455100	793A-1.11/16	80	25	75	86	7933-75	7934-75	1	2200
0793100465100	793A-1.3/4	80	25,5	75	86	7933-75	7934-75	1	2200
0793100475100	793A-1.13/16	80	25,5	75	86	7933-75	7934-75	1	2200
0793100485100	793A-1.7/8	82	27	80	86	7933-75	7934-75	1	2300
0793100485101	793A-1.15/16	82	27	80	86	7933-75	7934-75	1	2300
0793100495100	793A-2	82	27	80	86	7933-75	7934-75	1	2300
0793100505100	793A-2.1/16	89	30	86	86	7933-75	7934-75	1	2500
0793100515100	793A-2.1/8	89	30	86	86	7933-75	7934-75	1	2500
0793100525100	793A-2.3/16	92	32	86	86	7933-75	7934-75	1	2500
0793100535100	793A-2.1/4	92	32,5	86	86	7933-75	7934-75	1	2500
0793100545100	793A-2.5/16	92	33	92	86	7933-75	7934-75	1	2800
0793100555100	793A-2.3/8	96	35	92	86	7933-75	7934-75	1	2800
0793100565100	793A-2.7/16	96	35	96	86	7933-75	7934-75	1	3200
0793100575100	793A-2.1/2	96	35	100	86	7933-75	7934-75	1	3350
0793100585100	793A-2.9/16	96	35	100	86	7933-75	7934-75	1	3350
0793100595100	793A-2.5/8	100	38	101	86	7933-75	7934-75	1	3350
0793100595101	793A-2.11/16	101	38	101	86	7933-75	7934-75	1	3600
0793100605100	793A-2.3/4	101	38	105	86	7933-75	7934-75	1	3600
0793100615100	793A-2.13/16	105	40	109	86	7933-75	7934-75	1	3900
0793100615101	793A-2.7/8	105	41	109	86	7933-75	7934-75	1	3900
0793100625100	793A-2.15/16	105	41	109	86	7933-75	7934-75	1	3900
0793100635100	793A-3	110	44	115	86	7933-75	7934-75	1	4500
0793100635101	793A-3.1/16	110	44	115	86	7933-75	7934-75	1	4500
0793100645100	793A-3.1/8	110	44	115	86	7933-75	7934-75	1	4500
0793100645101	793A-3.3/16	110	44	115	86	7933-75	7934-75	1	5100
0793100655100	793A-3.1/4	116	47	121	86	7933-75	7934-75	1	5100

to be continued next page

Code	Number	l/mm ┌──┐	l1 mm	d1 mm	d2 mm	Locking Pin	Locking Ring	Pieces ☞	Weight/g ⚖
0793100655101	793A-3.5/16	116	47	121	86	7933-75	7934-75	1	5100
0793100665100	793A-3.3/8	116	49	127	86	7933-75	7934-75	1	5500
0793100665101	793A-3.7/16	118	49	127	86	7933-75	7934-75	1	5500
0793100675100	793A-3.1/2	118	49	130	86	7933-75	7934-75	1	5600
0793100675101	793A-3.9/16	118	49	130	86	7933-75	7934-75	1	5600
0793100685100	793A-3.5/8	118	49	135	127	7933-116	7934-116	1	7900
0793100685101	793A-3.11/16	118	49	135	127	7933-116	7934-116	1	7900
0793100695100	793A-3.3/4	118	49	135	127	7933-116	7934-116	1	7900
0793100695101	793A-3.13/16	125	54	140	127	7933-116	7934-116	1	8500
0793100705100	793A-3.7/8	125	54	140	127	7933-116	7934-116	1	8500
0793100705101	793A-3.15/16	125	54	140	127	7933-116	7934-116	1	8500
0793100715100	793A-4	125	54	145	127	7933-116	7934-116	1	9000
0793100715101	793A-4.1/16	125	54	145	127	7933-116	7934-116	1	9000
0793100725100	793A-4.1/8	125	54	150	127	7933-116	7934-116	1	9500
0793100725101	793A-4.3/16	137	62	150	127	7933-116	7934-116	1	10200
0793100735100	793A-4.1/4	137	62	150	127	7933-116	7934-116	1	10200
0793100735102	793A-4.3/8	137	62	155	127	7933-116	7934-116	1	10400
0793100735101	793A-4.5/16	137	62	155	127	7933-116	7934-116	1	10400
0793100735103	793A-4.7/16	137	62	155	127	7933-116	7934-116	1	10400
0793100745100	793A-4.1/2	137	62	160	127	7933-116	7934-116	1	11500
0793100755100	793A-4.5/8	143	67	165	127	7933-116	7934-116	1	12000
0793100755101	793A-4.3/4	145	67	165	127	7933-116	7934-116	1	12000
0793100765100	793A-4.7/8	145	67	170	127	7933-116	7934-116	1	12200
0793100775100	793A-5	150	72	180	127	7933-116	7934-116	1	14800
0793100775101	793A-5.1/8	158	76	180	127	7933-116	7934-116	1	14800

04

**793IN-..., 793INA-...**  
**IMPACT SOCKET 1.1/2"**

- ▶ for power tools
- ▶ for inside hexagon screws
- ▶ with exchangeable blades
- ▶ special steel, phosphated
- ▶ female square drive according to DIN 3121-H 40, ISO 1174

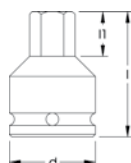

40

1.1/2"



Code	Number	l/mm ┌──┐	l1 mm	d mm	Locking Pin	Locking Ring	Pieces ☞	Weight/g ⚖
0793010245100	793IN-24	120	24	86	7933-75	7934-75	1	2600
0793010275100	793IN-27	120	27	86	7933-75	7934-75	1	2600
0793010305100	793IN-30	125	30	86	7933-75	7934-75	1	2800
0793010325100	793IN-32	125	32	86	7933-75	7934-75	1	2800
0793010365100	793IN-36	145	36	86	7933-75	7934-75	1	3400
0793010415100	793IN-41	145	41	86	7933-75	7934-75	1	3520
0793010465100	793IN-46	155	46	86	7933-75	7934-75	1	4700
0793010505100	793IN-50	155	50	86	7933-75	7934-75	1	4900
0793010555100	793IN-55	155	55	86	7933-75	7934-75	1	5100



Code	Number	l/mm ┌──┐	l1 mm	d mm	Locking Pin	Locking Ring	Pieces ☞	Weight/g ⚖
0793110345100	793INA-1	120	25	86	7933-75	7934-75	1	2600
0793110365100	793INA-1.1/8	120	28	86	7933-75	7934-75	1	2600
0793110385100	793INA-1.1/4	125	32	86	7933-75	7934-75	1	2600
0793110405100	793INA-1.3/8	145	35	86	7933-75	7934-75	1	3400
0793110425100	793INA-1.1/2	145	38	86	7933-75	7934-75	1	3400
0793110445100	793INA-1.5/8	145	41	86	7933-75	7934-75	1	3520
0793110465100	793INA-1.3/4	155	44	86	7933-75	7934-75	1	3520
0793110475100	793INA-1.13/16	155	46	86	7933-75	7934-75	1	4700
0793110485100	793INA-1.7/8	155	48	86	7933-75	7934-75	1	4900
0793110495100	793INA-2	155	51	86	7933-75	7934-75	1	4900
0793110515100	793INA-2.1/8	155	54	86	7933-75	7934-75	1	5100

## 7933-.../7934-...

### IMPACT LOCKING PIN AND RING FOR IMPACT SOCKET 1.1/2"

- ▶ for locking impact sockets and operating tools
- ▶ locking pin made of alloyed special steel
- ▶ locking ring made of rubber elastic and oil resistant material



Code	Number	l/mm	mm Ø	Pieces	Weight/g
7933000675100	7933-67	67	6,0	12	15,0
7933000755100	7933-75	75	6,0	12	15,0
7933001165100	7933-116	116	6,0	12	25,0
7934000675100	7934-67	-	67	12	8,0
7934000755100	7934-75	-	75	12	8,0
7934001165100	7934-116	-	116	12	15,0

## 793LT-..., 793LTA-...

### IMPACT SOCKET 1.1/2", EXTRA DEEP, HEXAGON

- ▶ for power tools
- ▶ special steel, phosphated
- ▶ female square drive according to DIN 3121-H 40, ISO 1174



Code	Number	l/mm	l1 mm	d1 mm	d2 mm	Locking Pin	Locking Ring	Pieces	Weight/g
0793020415100	793LT-41	140	22	70	86	7933-75	7934-75	1	4500
0793020465100	793LT-46	140	25,5	75	86	7933-75	7934-75	1	4500
0793020505100	793LT-50	140	27	80	86	7933-75	7934-75	1	4500
0793020555100	793LT-55	140	30	86	86	7933-75	7934-75	1	4500
0793020605100	793LT-60	140	33	92	86	7933-75	7934-75	1	4600
0793020655100	793LT-65	140	35	100	86	7933-75	7934-75	1	4900
0793020705100	793LT-70	140	38	105	86	7933-75	7934-75	1	5000
0793020755100	793LT-75	140	41	109	86	7933-75	7934-75	1	5600
0793020805100	793LT-80	140	44	115	86	7933-75	7934-75	1	5900
0793020855100	793LT-85	140	47	121	86	7933-75	7934-75	1	6200
0793020905100	793LT-90	140	49	130	86	7933-75	7934-75	1	6800
0793020955100	793LT-95	150	49	135	127	7933-116	7934-116	1	9900
0793021005100	793LT-100	150	54	140	127	7933-116	7934-116	1	10700
0793021055100	793LT-105	150	54	150	127	7933-116	7934-116	1	11900
0793021105100	793LT-110	160	62	155	127	7933-116	7934-116	1	12500
0793021155100	793LT-115	160	67	160	127	7933-116	7934-116	1	13200
0793021205100	793LT-120	170	67	165	127	7933-116	7934-116	1	14300

Further sizes on request



Code	Number	l/mm	l1 mm	d1 mm	d2 mm	Locking Pin	Locking Ring	Pieces	Weight/g
0793120435100	793LTA-1.9/16	140	22	70	86	7934-75	7933-75	1	4500
0793120445100	793LTA-1.5/8	140	22	70	86	7934-75	7933-75	1	4500
0793120455100	793LTA-1.11/16	140	25	75	86	7934-75	7933-75	1	4500
0793120465100	793LTA-1.3/4	140	25,5	75	86	7934-75	7933-75	1	4500
0793120475100	793LTA-1.13/16	140	25,5	75	86	7934-75	7933-75	1	4500
0793120485100	793LTA-1.7/8	140	27	80	86	7934-75	7933-75	1	4500
0793120495100	793LTA-2	140	27	80	86	7934-75	7933-75	1	4500

to be continued next page



Code	Number	l/mm	l1 mm	d1 mm	d2 mm	Locking Pin	Locking Ring	Pieces	Weight/g
0793120505100	793LTA-2.1/16	140	30	86	86	7934-75	7933-75	1	4500
0793120525100	793LTA-2.3/16	140	32	86	86	7934-75	7933-75	1	4500
0793120535100	793LTA-2.1/4	140	32,5	86	86	7934-75	7933-75	1	4500
0793120555100	793LTA-2.3/8	140	35	92	86	7934-75	7933-75	1	4600
0793120585100	793LTA-2.9/16	140	35	100	86	7934-75	7933-75	1	4900
0793120595100	793LTA-2.5/8	140	38	100	86	7934-75	7933-75	1	4900
0793120605100	793LTA-2.3/4	140	38	105	86	7934-75	7933-75	1	5000
0793120615101	793LTA-2.7/8	140	41	109	86	7934-75	7933-75	1	5600
0793120625100	793LTA-2.15/16	140	41	109	86	7934-75	7933-75	1	5600
0793120635100	793LTA-3	140	44	115	86	7934-75	7933-75	1	5900
0793120645100	793LTA-3.1/8	140	44	115	86	7934-75	7933-75	1	5900
0793120665100	793LTA-3.3/8	140	49	127	86	7934-75	7933-75	1	6600
0793120665101	793LTA-3.7/16	140	49	127	86	7934-75	7933-75	1	6600
0793120675100	793LTA-3.1/2	140	49	130	86	7934-75	7933-75	1	9900
0793120685100	793LTA-3.5/8	140	49	135	127	7934-116	7933-116	1	9900
0793120695100	793LTA-3.3/4	150	49	135	127	7934-116	7933-116	1	9900
0793120695101	793LTA-3.13/16	150	54	140	127	7934-116	7933-116	1	10700
0793120705100	793LTA-3.7/8	150	54	140	127	7934-116	7933-116	1	10700
0793120715100	793LTA-4	150	54	145	127	7934-116	7933-116	1	11200
0793120725100	793LTA-4.1/8	150	54	150	127	7934-116	7933-116	1	11900
0793120735100	793LTA-4.1/4	160	62	150	127	7934-116	7933-116	1	11900
0793120745100	793LTA-4.1/2	160	62	160	127	7934-116	7933-116	1	13200
0793120755100	793LTA-4.5/8	170	67	165	127	7934-116	7933-116	1	14300
0793120775100	793LTA-5	180	72	180	127	7934-116	7933-116	1	18200
0793120795100	793LTA-5.3/8	185	76	190	127	7934-116	7933-116	1	19000

Further sizes on request

**You will find the matching automotive special sockets on page no. 436**



**794-..., 794A-...**

**IMPACT SOCKET 2.1/2", HEXAGON**

- for power tools
- special steel, phosphated
- female square drive according to DIN 3121-H 63, ISO1174
- according to DIN 3129, ISO 2725-2

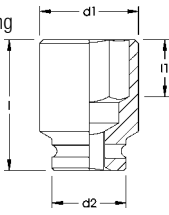

63

2.1/2"



Code	Number	l/mm	l1 mm	d1 mm	d2 mm	Locking Pin	Locking Ring	Pieces	Weight/g
0794000415100	794-41	115	21,5	104	127	7935-110	7936-114	1	7000
0794000465100	794-46	115	25,5	104	127	7935-110	7936-114	1	7000
0794000505100	794-50	115	27	104	127	7935-110	7936-114	1	7000
0794000555100	794-55	115	30	104	127	7935-110	7936-114	1	7000
0794000605100	794-60	115	35	104	127	7935-110	7936-114	1	7000
0794000655100	794-65	115	35	104	127	7935-110	7936-114	1	7000
0794000705100	794-70	115	38	104	127	7935-110	7936-114	1	7000
0794000755100	794-75	125	41	115	127	7935-110	7936-114	1	7600
0794000805100	794-80	125	44	115	127	7935-110	7936-114	1	7600
0794000855100	794-85	130	47	127	127	7935-110	7936-114	1	8000
0794000905100	794-90	132	49	135	127	7935-110	7936-114	1	8100
0794000955100	794-95	132	49	140	127	7935-110	7936-114	1	8200
0794001005100	794-100	141	54	145	127	7935-110	7936-114	1	9000
0794001055100	794-105	141	54	150	127	7935-110	7936-114	1	9600
0794001105100	794-110	150	62	160	127	7935-110	7936-114	1	11000
0794001155100	794-115	150	62	165	127	7935-110	7936-114	1	11500
0794001205100	794-120	158	67	170	127	7935-110	7936-114	1	12000
0794001255100	794-125	158	67	170	127	7935-110	7936-114	1	12000
0794001305100	794-130	174	76	180	127	7935-110	7936-114	1	14100
0794001355100	794-135	174	76	190	127	7935-110	7936-114	1	17000
0794001405100	794-140	176	79	190	127	7935-110	7936-114	1	17000
0794001455100	794-145	182	83	200	150	7935-133	7936-136	1	20000
0794001505100	794-150	190	88	210	150	7935-133	7936-136	1	22000
0794001555100	794-155	190	88	210	150	7935-133	7936-136	1	22000
0794001605100	794-160	194	91	220	150	7935-133	7936-136	1	23000

Further sizes on request



Code	Number	l/mm	l1 mm	d1 mm	d2 mm	Locking Pin	Locking Ring	Pieces	Weight/g
0794100445100	794A-1.5/8	115	21,5	104	127	7935-110	7936-114	1	7000
0794100455100	794A-1.11/16	115	25	104	127	7935-110	7936-114	1	7000
0794100465100	794A-1.3/4	115	25,5	104	127	7935-110	7936-114	1	7000
0794100475100	794A-1.13/16	115	25,5	104	127	7935-110	7936-114	1	7000
0794100485100	794A-1.7/8	115	27	104	127	7935-110	7936-114	1	7000
0794100485101	794A-1.15/16	115	27	104	127	7935-110	7936-114	1	7000
0794100495100	794A-2	115	27	104	127	7935-110	7936-114	1	7000
0794100505100	794A-2.1/16	115	30	104	127	7935-110	7936-114	1	7000
0794100515100	794A-2.1/8	115	30	104	127	7935-110	7936-114	1	7000
0794100525100	794A-2.3/16	115	32	104	127	7935-110	7936-114	1	7000
0794100535100	794A-2.1/4	115	32,5	104	127	7935-110	7936-114	1	7000
0794100545100	794A-2.5/16	115	33	104	127	7935-110	7936-114	1	7000
0794100555100	794A-2.3/8	115	35	104	127	7935-110	7936-114	1	7000
0794100565100	794A-2.7/16	115	35	104	127	7935-110	7936-114	1	7000
0794100575100	794A-2.1/2	115	35	104	127	7935-110	7936-114	1	7000
0794100585100	794A-2.9/16	115	35	104	127	7935-110	7936-114	1	7000

to be continued next page

Code	Number	l/mm ┌──┐	l1 mm	d1 mm	d2 mm	Locking Pin	Locking Ring	Pieces ☞	Weight/g ⚖
0794100595100	794A-2.5/8	115	38	104	127	7935-110	7936-114	1	7000
0794100595101	794A-2.11/16	115	38	104	127	7935-110	7936-114	1	7000
0794100605100	794A-2.3/4	115	38	104	127	7935-110	7936-114	1	7000
0794100615100	794A-2.13/16	125	40	115	127	7935-110	7936-114	1	7600
0794100615101	794A-2.7/8	125	41	115	127	7935-110	7936-114	1	7600
0794100625100	794A-2.15/16	125	41	115	127	7935-110	7936-114	1	7600
0794100635100	794A-3	125	44	115	127	7935-110	7936-114	1	7600
0794100645100	794A-3.1/8	125	44	127	127	7935-110	7936-114	1	7600
0794100655100	794A-3.1/4	130	47	127	127	7935-110	7936-114	1	8000
0794100665101	794A-3.7/16	132	49	135	127	7935-110	7936-114	1	8100
0794100675100	794A-3.1/2	132	49	135	127	7935-110	7936-114	1	8100
0794100685100	794A-3.5/8	132	49	135	127	7935-110	7936-114	1	8100
0794100695100	794A-3.3/4	132	49	140	127	7935-110	7936-114	1	8200
0794100705100	794A-3.7/8	141	54	145	127	7935-110	7936-114	1	9000
0794100715100	794A-4	141	54	150	127	7935-110	7936-114	1	9600
0794100715101	794A-4.1/16	141	54	150	127	7935-110	7936-114	1	9600
0794100725100	794A-4.1/8	141	54	150	127	7935-110	7936-114	1	9600
0794100735100	794A-4.1/4	150	62	155	127	7935-110	7936-114	1	10500
0794100745100	794A-4.1/2	150	62	165	127	7935-110	7936-114	1	11300
0794100755100	794A-4.5/8	158	67	170	127	7935-110	7936-114	1	12000
0794100755101	794A-4.3/4	158	67	170	127	7935-110	7936-114	1	12000
0794100765100	794A-4.7/8	158	67	170	127	7935-110	7936-114	1	12000
0794100775100	794A-5	165	72	180	127	7935-110	7936-114	1	14100
0794100775101	794A-5.1/8	174	76	180	127	7935-110	7936-114	1	14100
0794100785100	794A-5.1/4	174	76	190	127	7935-110	7936-114	1	17000
0794100795100	794A-5.3/8	174	76	190	127	7935-110	7936-114	1	17000
0794100805100	794A-5.5/8	182	83	200	150	7935-133	7936-136	1	20000
0794100815100	794A-5.3/4	182	83	200	150	7935-133	7936-136	1	20000

Further sizes on request

**7935-.../7936-...**

**IMPACT LOCKING PIN AND RING FOR IMPACT SOCKETS 2.1/2"**

- ▶ for locking impact sockets and operating tools
- ▶ locking pin made of alloyed special steel
- ▶ locking ring made of rubber elastic and oil resistant material

Code	Number	l/mm ┌──┐	mm ∅	Pieces ☞	Weight/g ⚖
7935001105100	7935-110	110	8,0	12	30
7935001335100	7935-133	133	8,0	12	50
7936001145100	7936-114	-	114	12	45
7936001365100	7936-136	-	136	12	50



### 4100-IS... SCREWDRIVER BIT 1/4"

- ▶ for plain slotted screws
- ▶ ELORA-Chrome-Molybdenum-Vanadium 73MoV5-2 / 1.2381
- ▶ male hexagon according to DIN 3126 E 6,3, DIN ISO 1173
- ▶ according to DIN ISO 2351-1



6,3

1/4"



Code	Number	l/mm	Pieces	Weight/g
4100005045200	4100-IS 0,5x4	50	12	8
4100008045200	4100-IS 0,8x4	50	12	9
4100016085200	4100-IS 1,6x8	50	12	15
4100016095200	4100-IS 1,6x9	50	12	16
4100016115200	4100-IS 1,6x11	50	12	20
4100020125200	4100-IS 2x12	50	12	22

### 4120-PH... SCREWDRIVER BIT 1/4"

- ▶ for cross slotted screws PH
- ▶ ELORA-Chrome-Molybdenum-Vanadium 73MoV5-2 / 1.2381
- ▶ male hexagon according to DIN 3126 E 6,3, DIN ISO 1173
- ▶ according to DIN ISO 2351-2, tip according to DIN ISO 8764-1 PH



6,3

1/4"



Code	Number	l/mm	Pieces	Weight/g
412000005200	4120-PH 0	50	12	7,6
412000015200	4120-PH 1	50	12	8,8
412000025200	4120-PH 2	50	12	10,0
412000035200	4120-PH 3	50	12	12,0

### 4130-PZ... SCREWDRIVER BIT 1/4"

- ▶ for cross slotted screws PZ
- ▶ ELORA-Chrome-Molybdenum-Vanadium 73MoV5-2 / 1.2381
- ▶ male hexagon according to DIN 3126 E 6,3, DIN ISO 1173
- ▶ according to DIN ISO 2351-2, tip according to DIN ISO 8764-1 PZ



6,3

1/4"



Code	Number	l/mm	Pieces	Weight/g
413000005200	4130-PZ 0	50	12	7,6
413000015200	4130-PZ 1	50	12	8,8
413000025200	4130-PZ 2	50	12	10,8
413000035200	4130-PZ 3	50	12	12,4
413000045200	4130-PZ 4	50	12	18,0

### 4110-IN SCREWDRIVER BIT 1/4"

- ▶ for inside hexagon screws
- ▶ ELORA-Chrome-Molybdenum-Vanadium 73MoV5-2 / 1.2381
- ▶ male hexagon according to DIN 3126 E 6,3, DIN ISO 1173
- ▶ according to DIN ISO 2351-3



6,3

1/4"



Code	Number	l/mm	Pieces	Weight/g
4110000305200	4110-IN 3	50	12	8,4
4110000405200	4110-IN 4	50	12	10,8
4110000505200	4110-IN 5	50	12	11,2
4110000605200	4110-IN 6	50	12	12,8
4110000705200	4110-IN 7	50	12	15,2
4110000805200	4110-IN 8	50	12	16,5
4110001005200	4110-IN 10	50	12	22,4

### 4160-TX... SCREWDRIVER BIT 1/4"

- ▶ for inside TORX® screws
- ▶ ELORA-Chrome-Molybdenum-Vanadium 73MoV5-2 / 1.2381
- ▶ male hexagon according to DIN 3126 E 6,3, DIN ISO 1173
- ▶ TORX® = reg. trademark of Acument Intellectual Properties, LLC. USA



6,3

1/4"



Code	Number	l/mm	Pieces	Weight/g
4160000105200	4160-TX10	2,74	6	10,4
4160000155200	4160-TX15	3,27	6	10,4
4160000205200	4160-TX20	3,86	6	11,6
4160000255200	4160-TX25	4,43	6	14,8
4160000275200	4160-TX27	4,99	6	13,2
4160000305200	4160-TX30	5,52	6	15,2
4160000405200	4160-TX40	6,65	6	17,6

### 3000-IS... SCREWDRIVER BIT 1/4"

- ▶ for plain slotted screws
- ▶ ELORA-Chrome-Molybdenum-Vanadium 73MoV5-2 / 1.2381
- ▶ male hexagon according to DIN 3126 C 6,3, DIN ISO 1173
- ▶ according to DIN ISO 2351-1



6,3

1/4"



Code	Number	l/mm	Pieces	Weight/g
3000005035200	3000-IS 0,5x 3	39	12	5
3000005045200	3000-IS 0,5x 4	39	12	5,3
3000006355200	3000-IS 0,6x3,5	39	12	6
3000006045200	3000-IS 0,6x4	39	12	5,5
3000006455200	3000-IS 0,6x4,5	39	12	7
3000008045200	3000-IS 0,8x4	39	12	7
3000008555200	3000-IS 0,8x5,5	39	12	7
3000010555200	3000-IS 1,0x5,5	39	12	7,5
3000012655200	3000-IS 1,2x6,5	39	12	11,6
3000012085200	3000-IS 1,2x8	39	12	8,7
3000016085200	3000-IS 1,6x8	39	12	11,6
3000016105200	3000-IS 1,6x10	39	12	15,6



### 3020-PH... SCREWDRIVER BIT 1/4"

- ▶ for cross slotted screws PH
- ▶ ELORA-Chrome-Molybdenum-Vanadium 73MoV5-2 / 1.2381
- ▶ male hexagon according to DIN 3126 C 6,3, DIN ISO 1173
- ▶ according to ISO 2351-2, tip according to DIN ISO 8764-1 PH



6,3

1/4"



Code	Number	l/mm	Pieces	Weight/g
3020001255200	3020-PH 1x25	25	12	4,8
3020002255200	3020-PH 2x25	25	12	5,2
3020002325200	3020-PH 2x32	32	12	6,9
3020002505200	3020-PH 2x50	50	12	11,6
3020003255200	3020-PH 3x25	25	12	5,2
3020003325200	3020-PH 3x32	32	12	7,2

### 3021-PZ... SCREWDRIVER BIT 1/4"

- ▶ for cross slotted screws PZ
- ▶ ELORA-Chrome-Molybdenum-Vanadium 73MoV5-2 / 1.2381
- ▶ male hexagon according to DIN 3126 C 6,3, ISO 1173
- ▶ according to ISO 2351-2, tip according to DIN ISO 8764-1 PZ



6,3

1/4"



Code	Number	l/mm	Pieces	Weight/g
3021001255200	3021-PZ 1x25	25	12	5,5
3021002255200	3021-PZ 2x25	25	12	5,6
3021002505200	3021-PZ 2x50	50	12	12
3021003255200	3021-PZ 3x25	25	12	5,6
3021003325200	3021-PZ 3x32	32	12	7,4

### 3010-IN... SCREWDRIVER BIT 1/4"

- ▶ for inside hexagon screws
- ▶ ELORA-Chrome-Molybdenum-Vanadium 73MoV5-2 / 1.2381
- ▶ male hexagon according to DIN 3126 C 6,3, ISO 1173
- ▶ according to DIN ISO 2351-3



6,3

1/4"



Code	Number	l/mm	Pieces	Weight/g
3010000305200	3010-IN 3	25	12	5
3010000405200	3010-IN 4	25	12	5
3010000505200	3010-IN 5	25	12	5,4
3010000605200	3010-IN 6	25	12	6,0
3010001005200	3010-IN 10	25	12	11,2

### 3050-TX... SCREWDRIVER BIT 1/4"

- ▶ for inside TORX® screws
- ▶ ELORA-Chrome-Molybdenum-Vanadium 73MoV5-2 / 1.2381
- ▶ male hexagon according to DIN 3126 C 6,3, ISO 1173
- ▶ TORX® = reg. trademark of Acument Intellectual Properties, LLC. USA



6,3

1/4"



Code	Number	★ mm	l/mm	Pieces	Weight/g
3050000065200	3050-TX 6	1,69	25	12	4,2
3050000075200	3050-TX 7	1,99	25	12	4,3
3050000085200	3050-TX 8	2,31	25	12	4,4
3050000095200	3050-TX 9	2,5	25	12	4,4
3050000105200	3050-TX 10	2,74	25	12	4,5
3050000155200	3050-TX 15	3,27	25	12	4,6
3050000205200	3050-TX 20	3,86	25	12	5
3050000255200	3050-TX 25	4,43	25	12	5,2
3050000275200	3050-TX 27	4,99	25	12	5,4
3050000305200	3050-TX 30	5,52	25	12	5,6
3050000405200	3050-TX 40	6,65	25	12	6,4

### 3070-TTX... SCREWDRIVER BIT 1/4"

- ▶ for inside-TORX® safety screws
- ▶ ELORA-Chrome-Molybdenum-Vanadium 73MoV5-2 / 1.2381
- ▶ male hexagon according to DIN 3126 C 6,3, ISO 1173
- ▶ TORX® = reg. trademark of Acument Intellectual Properties, LLC. USA



6,3

1/4"



Code	Number	l/mm	★ mm	Pieces	Weight/g
3070000105200	3070-TTX 10	26	2,74	12	4,4
3070000155200	3070-TTX 15	26	3,27	12	4,6
3070000205200	3070-TTX 20	26	3,86	12	4,6
3070000255200	3070-TTX 25	26	4,43	12	5
3070000275200	3070-TTX 27	26	4,99	12	5,4
3070000305200	3070-TTX 30	26	5,52	12	5,4
3070000405200	3070-TTX 40	26	6,65	12	6

### 3050-IPR... SCREWDRIVER BIT 1/4"

- ▶ for TORX Plus® IPR-screws
- ▶ ELORA-Chrom-Molybdän-Vanadium 73MoV5-2 / 1.2381
- ▶ male hexagon according to DIN 3126 C 6,3, ISO 1173
- ▶ TORX® = reg. trademark of Acument Intellectual Properties, LLC. USA



6,3

1/4"



Code	Number	l/mm	Pieces	Weight/g
3050000105300	3050-IPR 10	25	12	4,5
3050000155300	3050-IPR 15	25	12	4,6
3050000205300	3050-IPR 20	25	12	5,0
3050000255300	3050-IPR 25	25	12	5,2
3050000275300	3050-IPR 27	25	12	5,4
3050000305300	3050-IPR 30	25	12	5,6
3050000405300	3050-IPR 40	25	12	6,4

### 3030-XZN...

#### SCREWDRIVER BIT 1/4"

- ▶ for inside multi-point B&S and XZN screws
- ▶ ELORA-Chrome-Molybdenum-Vanadium 73MoV5-2 / 1.2381
- ▶ male hexagon according to DIN 3126 C 6,3, ISO 1173



6,3

1/4"



Code	Number	l/mm	Pieces	Weight/g
3030000055200	3030-XZN M5	25	12	5,2
3030000065200	3030-XZN M6	25	12	5,6

### 3040-RIB...

#### SCREWDRIVER BIT 1/4"

- ▶ for RIBE®-CV-screws
- ▶ ELORA-Chrome-Molybdenum-Vanadium 73MoV5-2 / 1.2381
- ▶ male hexagon drive according to DIN 3126 C 6,3, ISO 1173
- ▶ RIBE® = reg. trademark of Richard Bergner GmbH & Co KG, Schwabach



6,3

1/4"



Code	Number	l/mm	Pieces	Weight/g
3040000055200	3040-RIB M5	32	12	5,0
3040000065200	3040-RIB M6	32	12	6,8
3040000085200	3040-RIB M8	32	12	10,0
3040000105200	3040-RIB M10	32	12	13,2

### 3080-...

#### DOUBLE FUNCTION SCREWDRIVER BIT 1/4"

- ▶ PH: cross-slotted head screws PH
- ▶ PZ: cross-slotted head screws PZ
- ▶ 1/4" hexagonal shank
- ▶ ELORA-Chrome-Molybdenum-Vanadium 73MoV5-2/ 1.2381



6,3

1/4"





Code	Number	l/mm	Pieces	Weight/g
3080010015260	3080-PH 1	0,6x4,5	12	13
3080010025260	3080-PH 2	0,8x5,5	12	14
3080010035260	3080-PH 3	1,0x7,0	12	16
3080020015260	3080-PZ 1	0,6x4,5	12	13
3080020025260	3080-PZ 2	0,8x5,5	12	14
3080020035260	3080-PZ 3	1,0x7,0	12	16

### 3100-IS...

#### SCREWDRIVER BIT 5/16"

- ▶ for plain slotted screws
- ▶ ELORA-Chrome-Molybdenum-Vanadium 73MoV5-2 / 1.2381
- ▶ male hexagon drive according to DIN 3126 C 8, DIN ISO 1173
- ▶ according to DIN ISO 2351-1



8

5/16"



Code	Number	l/mm	Pieces	Weight/g
3100008555200	3100-IS 0,8x5,5	41	12	9,6
3100010555200	3100-IS 1x5,5	41	12	10,4
3100012655200	3100-IS 1,2x6,5	41	12	12,4
3100012805200	3100-IS 1,2x8,0	41	12	16
3100016805200	3100-IS 1,6x8,0	41	12	16
3100020125200	3100-IS 2,0x12	41	12	24
3100025145200	3100-IS 2,5x14	41	12	30

### 3120-PH...

#### SCREWDRIVER BIT 5/16"

- ▶ for cross slotted screws PH
- ▶ ELORA-Chrome-Molybdenum-Vanadium 73MoV5-2 / 1.2381
- ▶ male hexagon drive according to DIN 3126 C 8, DIN ISO 1173
- ▶ according to DIN ISO 2351-2, tip according to DIN ISO 8764-1 PH



8

5/16"



Code	Number	l/mm	Pieces	Weight/g
3120001325200	3120-PH 1x32	32	12	10
3120002325200	3120-PH 2x32	32	12	10
3120003325200	3120-PH 3x32	32	12	11
3120004325200	3120-PH 4x32	32	12	11,5
3120004385200	3120-PH 4x38	38	12	17

### 3121-PZ...

#### SCREWDRIVER BIT 5/16"

- ▶ for cross slotted screws PZ
- ▶ ELORA-Chrome-Molybdenum-Vanadium 73MoV5-2 / 1.2381
- ▶ male hexagon according to DIN 3126 C 8, DIN ISO 1173
- ▶ according to DIN ISO 2351-2, tip according to DIN ISO 8764-1 PZ



8

5/16"



Code	Number	l/mm	Pieces	Weight/g
3121000015200	3121-PZ 1	32	12	10
3121000025200	3121-PZ 2	32	12	10
3121000035200	3121-PZ 3	32	12	10,4
3121000045200	3121-PZ 4	32	12	13,2

### 3110-IN... SCREWDRIVER BIT 5/16"

- ▶ for inside hexagon screws
- ▶ ELORA-Chrome-Molybdenum-Vanadium 73MoV5-2 / 1.2381
- ▶ male hexagon drive according to DIN 3126 C 8, DIN ISO 1173
- ▶ according to DIN ISO 2351-3



8

5/16"



Code	Number	l/mm	Pieces	Weight/g
3110000035200	3110-IN 3	30	12	7,6
3110000045200	3110-IN 4	30	12	9,6
3110000055200	3110-IN 5	30	12	8,9
3110000065200	3110-IN 6	30	12	10,4
3110000085200	3110-IN 8	30	12	12
3110000105200	3110-IN 10	30	12	14,4

### 3150-TX... SCREWDRIVER BIT 5/16"

- ▶ for inside TORX® screws
- ▶ ELORA-Chrome-Molybdenum-Vanadium 73MoV5-2 / 1.2381
- ▶ male hexagon drive according to DIN 3126 C 8, DIN ISO 1173
- ▶ TORX® = reg. trademark of Acument Intellectual Properties, LLC. USA



8

5/16"



Code	Number	★ mm	l/mm	Pieces	Weight/g
3150000255200	3150-TX 25	4,43	35	12	10,2
3150000275200	3150-TX 27	4,99	35	12	10,4
3150000305200	3150-TX 30	5,52	35	12	10,8
3150000405200	3150-TX 40	6,65	35	12	11,8
3150000455200	3150-TX 45	7,82	35	12	12,9
3150000505200	3150-TX 50	8,83	35	12	14,4
3150000555200	3150-TX 55	11,22	35	12	20,4

### 3130-XZN... SCREWDRIVER BIT 5/16"

- ▶ for inside multi-point B&S and XZN screws
- ▶ ELORA-Chrome-Molybdenum-Vanadium 73MoV5-2 / 1.2381
- ▶ male hexagon drive according to DIN 3126 C 8, DIN ISO 1173



8

5/16"



Code	Number	l/mm	Pieces	Weight/g
3130000055200	3130-XZN 5	28	12	8,4
3130000065200	3130-XZN 6	28	12	8,4
3130000085200	3130-XZN 8	28	12	9,6
3130000105200	3130-XZN 10	32	12	10,4
3130000125200	3130-XZN 12	36	12	22
3130000145200	3130-XZN 14	36	12	31

### 3170-TTX... SCREWDRIVER BIT 5/16"

- ▶ for inside-TORX® safety screws
- ▶ ELORA Chrome-Molybdenum-Vanadium 73MoV5-2 / 1.2381
- ▶ male hexagon drive according to DIN 3126 C 8, DIN ISO 1173
- ▶ TORX® = reg. trademark of Acument Intellectual Properties, LLC. USA



8

5/16"



Code	Number	★ mm	l/mm	Pieces	Weight/g
3170000255200	3170-TTX 25	4,43	35	12	10
3170000275200	3170-TTX 27	4,99	35	12	10
3170000305200	3170-TTX 30	5,52	35	12	11
3170000505200	3170-TTX 50	8,83	35	12	14
3170000555200	3170-TTX 55	11,22	35	12	20

### 3090 BIT RATCHET, STRAIGHT

- ▶ bit lock with permanent magnet
- ▶ reversible
- ▶ female hexagon drive according to DIN 3126 D 6,3 (1/4") and DIN 3126 D 8 (5/16")





6,3

8



1/4"

5/16"

Code	Number	l/mm	Pieces	Weight/g
3090000002000	3090	138	6	105

### 3090G BIT RATCHET, CRANKED

- ▶ bit lock with permanent magnet
- ▶ reversible
- ▶ female hexagon drive according to DIN 3126 D 6,3 (1/4") and DIN 3126 D 8 (5/16")





6,3

8



1/4"



5/16"

Code	Number	l/mm	Pieces	Weight/g
3090000102000	3090G	140	6	105

### 3415

#### HAND BIT HOLDER 1/4"

- ▶ bit lock with permanent magnet
- ▶ nonslip QUATROLIT®-2C-handle
- ▶ with suspension hole

6,3



1/4"



- ▶ ELORA-Chrome-Vanadium 31CrV3 / 1.2208
- ▶ female hexagon drive according to DIN 3126 D 6,3

Code	Number	l/mm	⊘	Pieces	Weight/g
341500000000	3415	180	1/4"	6	130

### 3300-...

#### ADAPTOR FOR SCREWDRIVER BITS

- ▶ for power tools
- ▶ bit lock with spring clip
- ▶ matt chrome plated
- ▶ ELORA-Chrome-Vanadium Steel 31CrV3 / 1.2208
- ▶ female hexagon drive according to DIN 3126 D 6,3 respectively DIN 3126 D 8; DIN ISO 1173
- ▶ female square drive according to DIN 3121 Form G
- ▶ according to DIN 7427 Form A

6,3

8

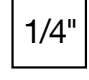

1/4"



5/16"

Code	Number	⊘	⊘	l/mm	Pieces	Weight/g
3300113132000	3300-1/4x1/4	1/4"	1/4"	25	6	18
3300119132000	3300-3/8x1/4	3/8"	1/4"	30	6	40,8
3300119172000	3300-3/8x5/16	3/8"	5/16"	30	6	41
3300123132000	3300-1/2x1/4	1/2"	1/4"	35	6	80
3300123172000	3300-1/2x5/16	1/2"	5/16"	35	6	64

### 4150-...

#### BITHOLDER 1/4"

- ▶ bit lock with permanent magnet resp. spring clips
- ▶ with stainless steel sleeve, diameter 9,5 mm
- ▶ female hexagon drive according to DIN 3126 D 6,3
- ▶ male hexagon drive according DIN 3126 E 6,3 DIN ISO 1173
- ▶ according to DIN 7427 Form D

6,3



1/4"

Code	Number	l/mm	⊘	⊘	Pieces	Weight/g
4150000505200	4150-50	50	1/4"	1/4" with spring clip and magnet	6	26
4150001005200	4150-100	100	1/4"	1/4" with spring clip and magnet	6	39

### 3428

#### BITHOLDER 1/4"

- ▶ bit lock with permanent magnet and quick clamping system
- ▶ quick locker and ejection system
- ▶ female hexagon drive according to DIN 3126 D 6,3
- ▶ male hexagon drive according DIN 3126 E 6,3, DIN ISO 1173



6,3



1/4"

Code	Number	l/mm	⊘	Pieces	Weight/g
3428000000000	3428	51	1/4"	6	24

### 3429

#### BITHOLDER 1/4"

- ▶ with strong ring magnet for holding the screw
- ▶ bit lock due to quick clamping system and ejection function
- ▶ female hexagon drive according to DIN 3126 D 6,3
- ▶ male hexagon drive according DIN 3126 E 6,3, DIN ISO 1173



6,3



1/4"

Code	Number	l/mm	⊘	Pieces	Weight/g
3429000000000	3429	60	1/4"	6	26



### 3452ST

#### BIT-BOX, STAINLESS 1/4"

- 19 pcs.
- bit holder ELORA-No. 3428 with quick clamping system and male hexagon drive according to DIN 3126 E 6,3
- bits made of stainless steel X46Cr13 / 1.4034, without galvanic surface treatment
- 18 bits with male hexagon drive according to DIN 3126 C 6,3

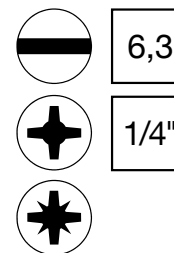

Code	Number	Contents	Pieces	Weight/g
3452500008000	3452ST	1 Magnetic quick action bit holder ELORA-No.3428 2 piece each plain slotted Screwdriver Bits 0,8x5,5, 1,0x5,5, 1,2x5,5 mm 2 piece each Philips Screwdriver Bits PH1, PH2, PH3 2 piece each Pozidriv Screwdriver Bits PZ1, PZ2, PZ3	1	180

### 3451-S7

#### BIT-BOX 1/4"

- 7 pcs.
- in black plastic box with transparent cover
- magnetic bit holder ELORA-No. 4150-50, with male hexagonal drive according to DIN 3126 E 6,3
- bits made of ELORA-Chrome-Molybdenum-Vanadium 73MoV5-2 / 1.2381
- 6 bits with male hexagon drive according to DIN 3126 C 6,3

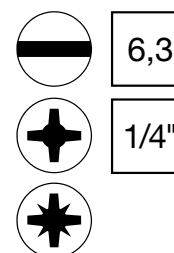

Code	Number	Contents	Pieces	Weight/g
3451500000000	3451-S7	1 Magnetic bit holder ELORA-No.4150-50 1 piece each plain slotted Screwdriver Bit 4,5x0,6, 6,5x1,2 mm 1 piece each Philips Screwdriver Bit PH1, PH2 1 piece each Pozidriv Screwdriver Bit PZ1, PZ2	1	108

### 3453-S11

#### BIT-BOX 1/4"

- 11 pcs.
- in black yellow plastic box with belt clip and suspension hole
- magnetic bit holder ELORA-No. 4150-50, with male hexagonal drive according to DIN 3126 E 6,3
- bits made of ELORA-Chrome-Molybdenum-Vanadium 73MoV5-2 / 1.2381
- 10 bits with male hexagon drive according to DIN 3126 C 6,3
- TORX® = reg. trademark of Acument Intellectual Properties, LLC. USA

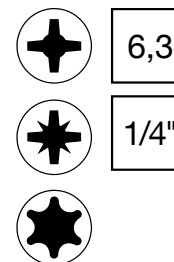

Code	Number	Contents	Pieces	Weight/g
3453000000000	3453-S11	1 Magnetic bit holder ELORA-No. 4150-50 1 piece each Philips Screwdriver Bit PH1, PH2 1 piece each Pozidriv Screwdriver Bit PZ1, PZ2 1 piece each TORX® Screwdriver-Bit TX10, TX15, TX20, TX25, TX30, TX40	1	125

### 3436-S36

#### BIT-BOX 1/4"

- 36 pcs.
- in black yellow plastic box with belt clip and suspension hole
- magnetic bit holder ELORA-No. 4150-50, with male hexagonal drive according to DIN 3126 E 6,3
- bits made of ELORA Chrome-Molybdenum-Vanadium 73MoV5-2 / 1.2381
- 35 bits with male hexagon drive according to DIN 3126 C 6,3
- TORX® = reg. trademark of Acument Intellectual Properties, LLC. USA

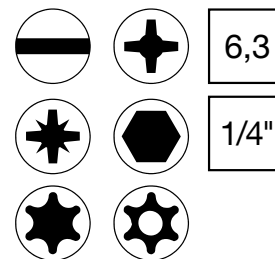

Code	Number	Contents	Pieces	Weight/g
3436000000000	3436-S36	1 Magnetic bit holder ELORA-No. 4150-50 1 piece each each plain slotted Screwdriver Bit 4,5, 5,5, 6,5 mm Phillips Screwdriver Bits 2x PH1, 3x PH2, 2x PH3 Poizidriv Screwdriver Bits 2x PZ1, 3x PZ2, 2x PZ3 1 piece each Inside hexagon Screwdriver Bit IN2, IN 2,5, IN3, IN4, IN5, IN5,5, IN6 1 piece each TORX®-Screwdriver Bit TX10, TX15, TX20, TX25, TX27, TX30, TX40 1 piece each TORX®-Screwdriver Bit TTX20, TTX25, TTX30 TTX40	1	340

### 3451-L...

#### BIT-BOX

- to fill with bits
- black plastic box with transparent cover
- with suspension hole



Code	Number	Contents	Pieces	Weight/g
3451500007001	3451-L1	empty, 5,5x4 cm	1	9
3451500007002	3451-L2	empty, 5,5x7,2 cm	1	13

### 3400

#### HAND OPERATED IMPACT DRIVER 1/2"

- for loosening tight screws with help of a hammer
- reversible with anti-slip plastic grip
- male square drive according to DIN 3120-A 12,5, ISO 1174, with ball locking device



Code	Number	l/mm	Pieces	Weight/g
3400000000000	3400	150	1	750

### 3401-S12

#### HAND OPERATED IMPACT DRIVER SET

- 12 pcs.
- in black metal case with plastic inlet
- for loosening tight screws with help of a hammer
- reversible with anti-slip plastic grip
- male square drive according to DIN 3120-A 12,5, ISO 1174, with locking device



Code	Number	Contents	Pieces	Weight/g
3401500120000	3401-S12	1 Hand Operated Impact Driver ELORA-No. 3400 1 Adaptor 3300-1/2x5/16 1 piece each Screwdriver Insert Bit, Plain Slot, 3100-IS 1,0x5,5, 1,2x6,5, 1,6x8,0, 2,0x12,0 mm 1 piece each Screwdriver Insert Bit, cross slot, 3120-PH 2x32, PH 3x32, PH 4x32 1 piece each Screwdriver Insert Bit, inside hexagon 3110-IN 6, IN 8, IN 10 mm	1	1385



